



Catalog Number: 363612-CT3R  
Item Description: CT3R HINGED PADLCKBL ENCL  
UPC Code: 784572161856

Brand Name: Milbank  
Type: Hinge Cover  
Special Features: Double Door  
Application: Current Transformer Enclosure  
Standard: UL Listed  
Material: Steel with Powder Coat Finish  
Cable Entry: No Knockouts  
Mounting: Pad Mount, Wall Mount  
NEMA Rating: Type 3R



*Utility requirements may vary. Always consult the serving utility for their requirements prior to ordering or installing this equipment. This product must always be installed by a licensed electrician. Installation of this equipment may require local electrical inspector approval.*

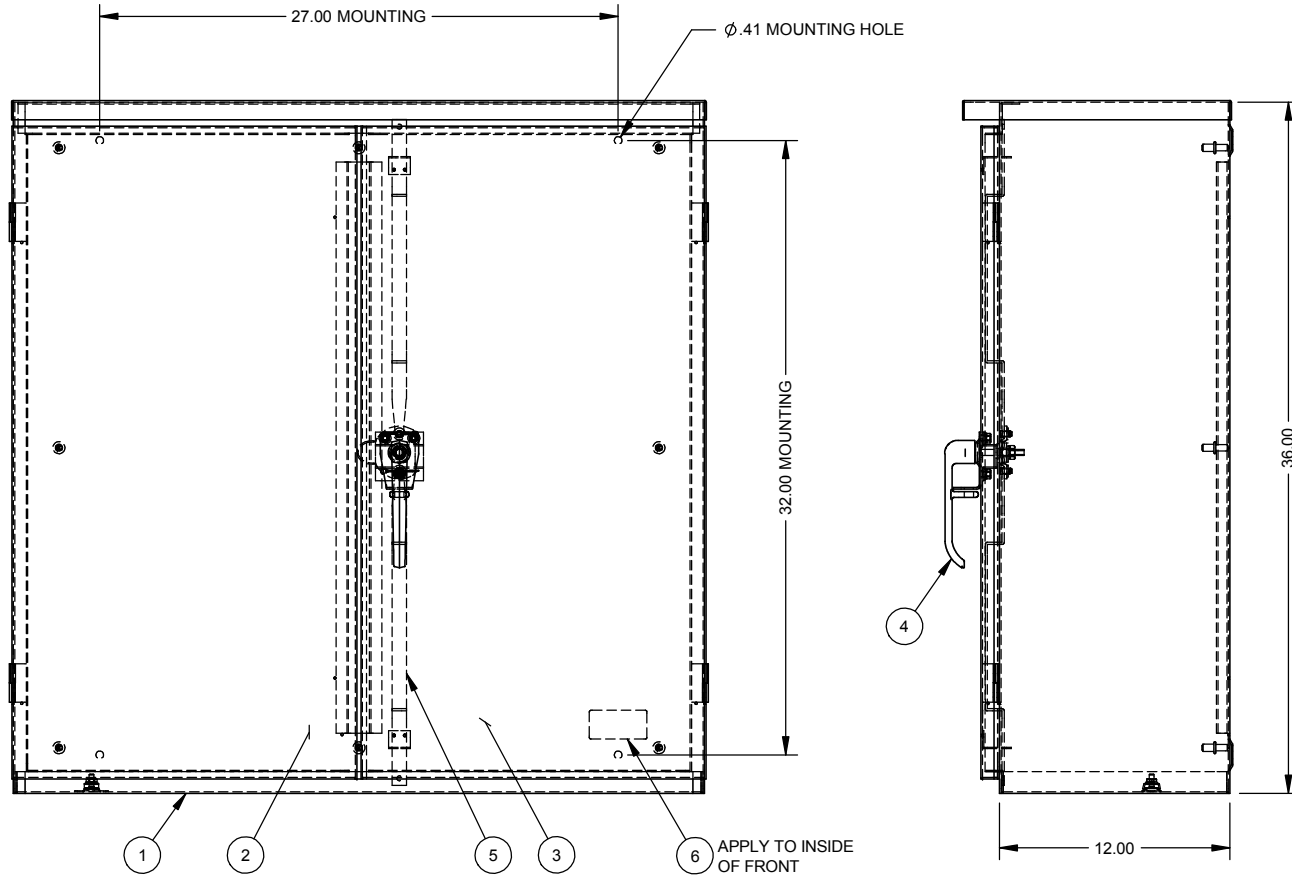

NO.	QTY.	PART NO.	DESCRIPTION
1	1	1138438	BACK WELDMENT
2	1	1004553	FRONT WELDMENT, LEFT
3	1	1004554	FRONT WELDMENT, RIGHT
4	1	1004575	ASSY, 3PT LATCH, PADLCKBL
5	2	1002051	LATCH SLIDE
6	1	1003115	LABEL (UL)
7	2	1002169	BAG ASSY (NOT SHOWN)
8	1	1003466	CARTON 1-PER (NOT SHOWN)

- NOTE:
- 1) PACK INSIDE ENCLOSURE (NOT SHOWN)
  2. FOR CATALOG NUMBER WITH -PI SUFFIX INSTALL 1096550 USING BAG ASSEMBLY(S) IN B.O.M.
  3. FOR CATALOG NUMBER WITH -WB SUFFIX INSTALL 1002359 USING BAG ASSEMBLY(S) IN B.O.M.
  4. WHEN SOLD AS (RC)- PREFIX USE LABEL #1125021 INSTEAD OF #1003115.
  5. SHIP ON 48" PALLET, 3 UNITS PER PALLET.

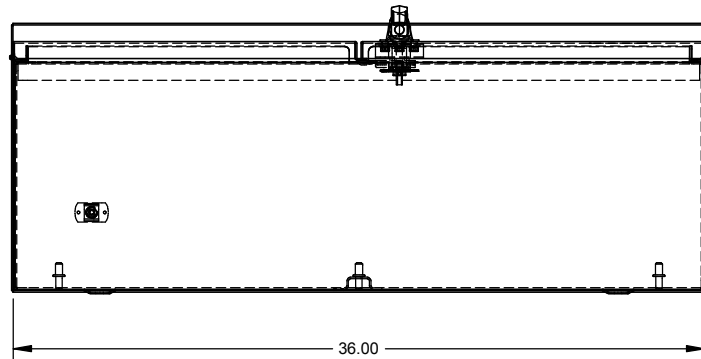

CAT#	MATERIAL	FINISH
363612-CT3R	GALVANIZED	ANSI 61 GRAY
363612-CT3R-PI	GALVANIZED	ANSI 61 GRAY
363612-CT3R-WB	GALVANIZED	ANSI 61 GRAY
363612-CT3RXS	304 STAINLESS	GRAINED

Material:	SEE CHART	<p>General Offices: Kansas City, MO</p>
Finish:	SEE CHART	
<p>Tolerances: Unless Specified Otherwise X.X ±.1 X.XX ±.03 X.XXX ±.015 X" ±2°</p>		<p>Title: 36 x 36 x 12, 2 DOOR TYPE 3R, FREE STANDING</p>
<p>Third Angle Projection</p>		<p>Catalog No.: SEE CHART</p>
		<p>Customer: MILBANK STANDARD</p>
		<p>Drawing No.: <b>1001905</b></p>
Scale: NTS	Checked By:	Date: 10/22/02
Drawn By: MR	Approved By:	Sheet 1 of 1

NEMA DWG.: #784

K	12/05/14	CHNG'D CARTON (eECR0030019)	AJS	J2	5/7/09	UPDATE TO M2K (ECO #18252)	D.F.	Scale:	NTS	Checked By:		Drawing No.:	<b>1001905</b>
J1	8-22-06	mECO #15092, ADDED NOTE #4.	CMW	J3	10/20/11	ADD NOTE 5 (ECO #21474)	D.F.	Drawn By:	MR	Approved By:		Date:	10/22/02



Catalog Number: 363612-CT3R  
Item Description: CT3R HINGED PADLCKBL ENCL  
UPC Code: 784572161856

Brand Name: Milbank  
Type: Hinge Cover  
Special Features: Double Door  
Application: Current Transformer Enclosure  
Standard: UL Listed  
Material: Steel with Powder Coat Finish  
Cable Entry: No Knockouts  
Mounting: Pad Mount, Wall Mount  
NEMA Rating: Type 3R



*Utility requirements may vary. Always consult the serving utility for their requirements prior to ordering or installing this equipment. This product must always be installed by a licensed electrician. Installation of this equipment may require local electrical inspector approval.*

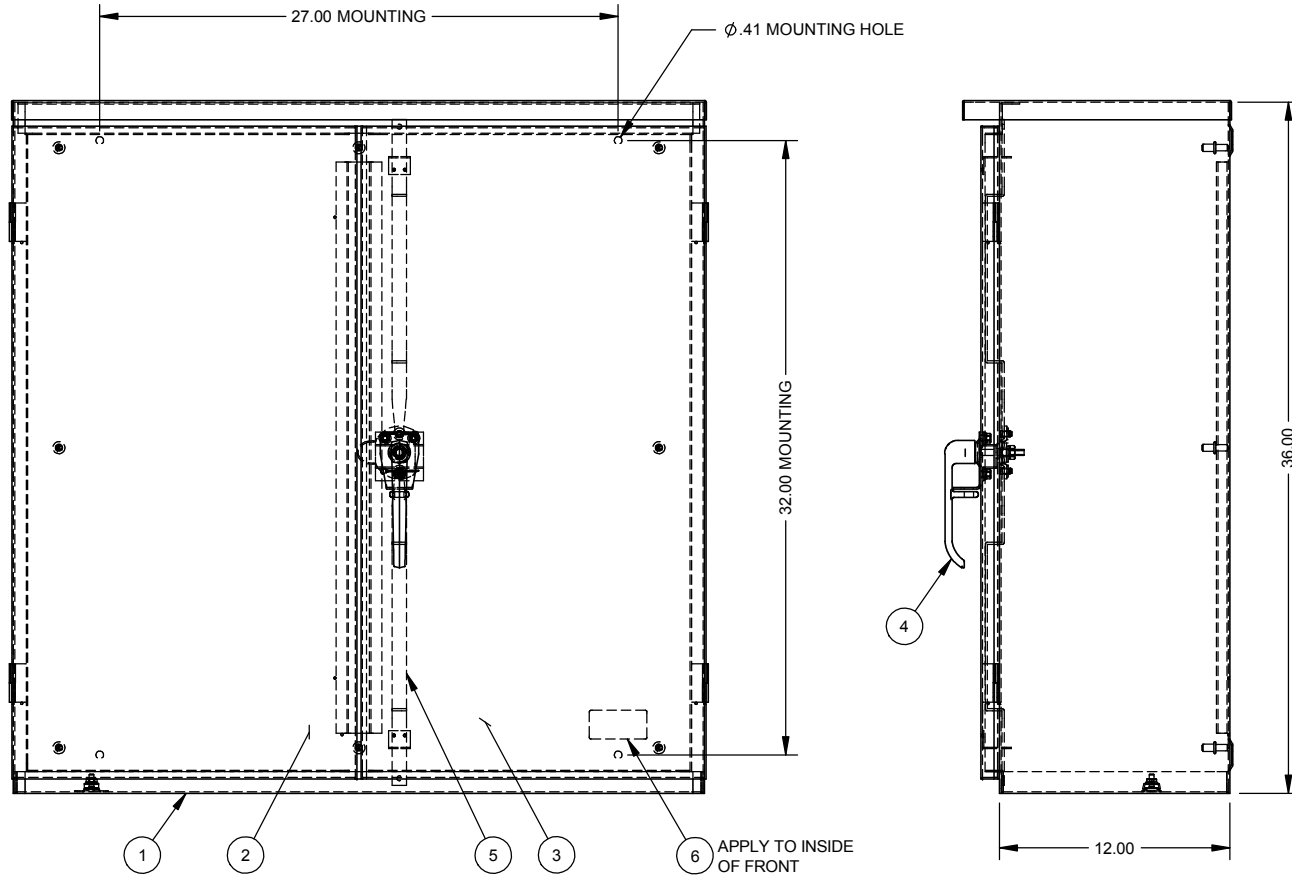

NO.	QTY.	PART NO.	DESCRIPTION
1	1	1138438	BACK WELDMENT
2	1	1004553	FRONT WELDMENT, LEFT
3	1	1004554	FRONT WELDMENT, RIGHT
4	1	1004575	ASSY, 3PT LATCH, PADLCKBL
5	2	1002051	LATCH SLIDE
6	1	1003115	LABEL (UL)
7	2	1002169	BAG ASSY (NOT SHOWN)
8	1	1003466	CARTON 1-PER (NOT SHOWN)

- NOTE:
- 1) PACK INSIDE ENCLOSURE (NOT SHOWN)
  2. FOR CATALOG NUMBER WITH -PI SUFFIX INSTALL 1096550 USING BAG ASSEMBLY(S) IN B.O.M.
  3. FOR CATALOG NUMBER WITH -WB SUFFIX INSTALL 1002359 USING BAG ASSEMBLY(S) IN B.O.M.
  4. WHEN SOLD AS (RC)- PREFIX USE LABEL #1125021 INSTEAD OF #1003115.
  5. SHIP ON 48" PALLET, 3 UNITS PER PALLET.

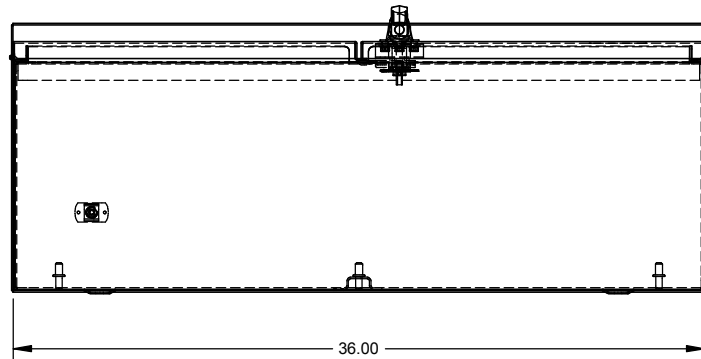

CAT#	MATERIAL	FINISH
363612-CT3R	GALVANIZED	ANSI 61 GRAY
363612-CT3R-PI	GALVANIZED	ANSI 61 GRAY
363612-CT3R-WB	GALVANIZED	ANSI 61 GRAY
363612-CT3RXS	304 STAINLESS	GRAINED

Material:	SEE CHART	<p>General Offices: Kansas City, MO</p>
Finish:	SEE CHART	
<p>Tolerances: Unless Specified Otherwise X.X ±.1 X.XX ±.03 X.XXX ±.015 X" ±2°</p>		<p>Title: 36 x 36 x 12, 2 DOOR TYPE 3R, FREE STANDING</p>
<p>Third Angle Projection</p>		<p>Catalog No.: SEE CHART</p>
		<p>Customer: MILBANK STANDARD</p>
		<p>Drawing No.: <b>1001905</b></p>
Scale: NTS	Checked By:	Date: 10/22/02
Drawn By: MR	Approved By:	Sheet 1 of 1

NEMA DWG.: #784

K	12/05/14	CHNG'D CARTON (eECR0030019)	AJS	J2	5/7/09	UPDATE TO M2K (ECO #18252)	D.F.	Scale:	NTS	Checked By:		Drawing No.:	<b>1001905</b>
J1	8-22-06	mECO #15092, ADDED NOTE #4.	CMW	J3	10/20/11	ADD NOTE 5 (ECO #21474)	D.F.	Drawn By:	MR	Approved By:		Date:	10/22/02