



Catalog Number: 88GE-NK  
Item Description: WIREWAY ACCESSORY  
UPC Code: 784572109797

Brand Name: Milbank  
Type: Wireway End  
Application: Wireway Accessory  
Standard: UL Listed, Type 1  
Cover Type: Screw Cover  
Enclosure: Indoor Enclosure  
Nominal Cross Section: 8x8  
Material: Steel with Powder Coat Finish  
Finish: ANSI 61 Gray  
Knockouts: False



*Utility requirements may vary. Always consult the serving utility for their requirements prior to ordering or installing this equipment. This product must always be installed by a licensed electrician. Installation of this equipment may require local electrical inspector approval.*

BILL OF MATERIAL		
NO.	QTY.	DESCRIPTION
1	1	1/2, 3/4, 1, 1 1/4, 1 1/2, 3 CONC.
2	6	ø .173
3	2	ø .250 (PAINT LINE HANGER)

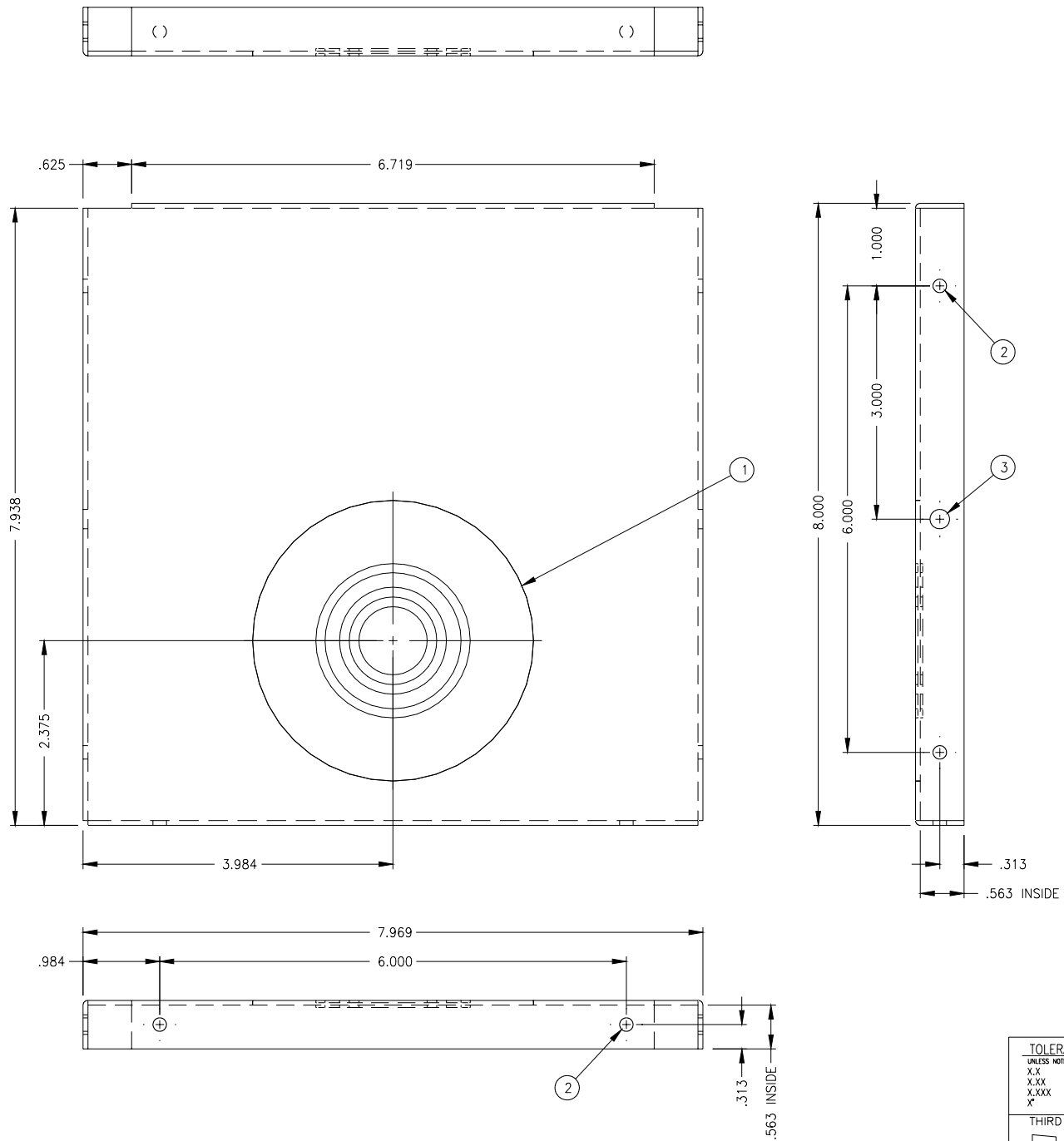

- NOTE:**
- 1. DIE RUN COMPLETE  
KC DIE #2876
  - 2. WHEN SOLD AS "-SSH",  
PACK WITH (2) 913638-SS.

REV.	DATE	DESCRIPTION	BY
H	9-24-98	CHANGE DIE LOCATION ALT #2032	KO
G	8-19-98	ADD HOLE PMR #2201	KO

MATERIAL	16 GA. GALVANIZED
FINISH	PAINTED MILBANK LIGHT GRAY
CATALOG NUMBER	88GE
TITLE	END COVER 8 x 8 GSC1 SCREW COVER WIREWAY

TOLERANCES: UNLESS NOTED OTHERWISE	
XX	± .1
X.XX	± .03
X.XXX	± .015
X"	± 2"
THIRD ANGLE	
PROJECTION	
DRAWN:	SEM
CHKD:	NTS
APPR:	

CUSTOMER	
DRAWING NUMBER	811097-11
SCALE:	NTS
DATE:	5-15-90
MILBANK MFG. CO. GENERAL OFFICES KANSAS CITY, MO.	



Catalog Number: 88GE-NK  
Item Description: WIREWAY ACCESSORY  
UPC Code: 784572109797

Brand Name: Milbank  
Type: Wireway End  
Application: Wireway Accessory  
Standard: UL Listed, Type 1  
Cover Type: Screw Cover  
Enclosure: Indoor Enclosure  
Nominal Cross Section: 8x8  
Material: Steel with Powder Coat Finish  
Finish: ANSI 61 Gray  
Knockouts: False



*Utility requirements may vary. Always consult the serving utility for their requirements prior to ordering or installing this equipment. This product must always be installed by a licensed electrician. Installation of this equipment may require local electrical inspector approval.*

BILL OF MATERIAL		
NO.	QTY.	DESCRIPTION
1	1	1/2, 3/4, 1, 1 1/4, 1 1/2, 3 CONC.
2	6	ø .173
3	2	ø .250 (PAINT LINE HANGER)

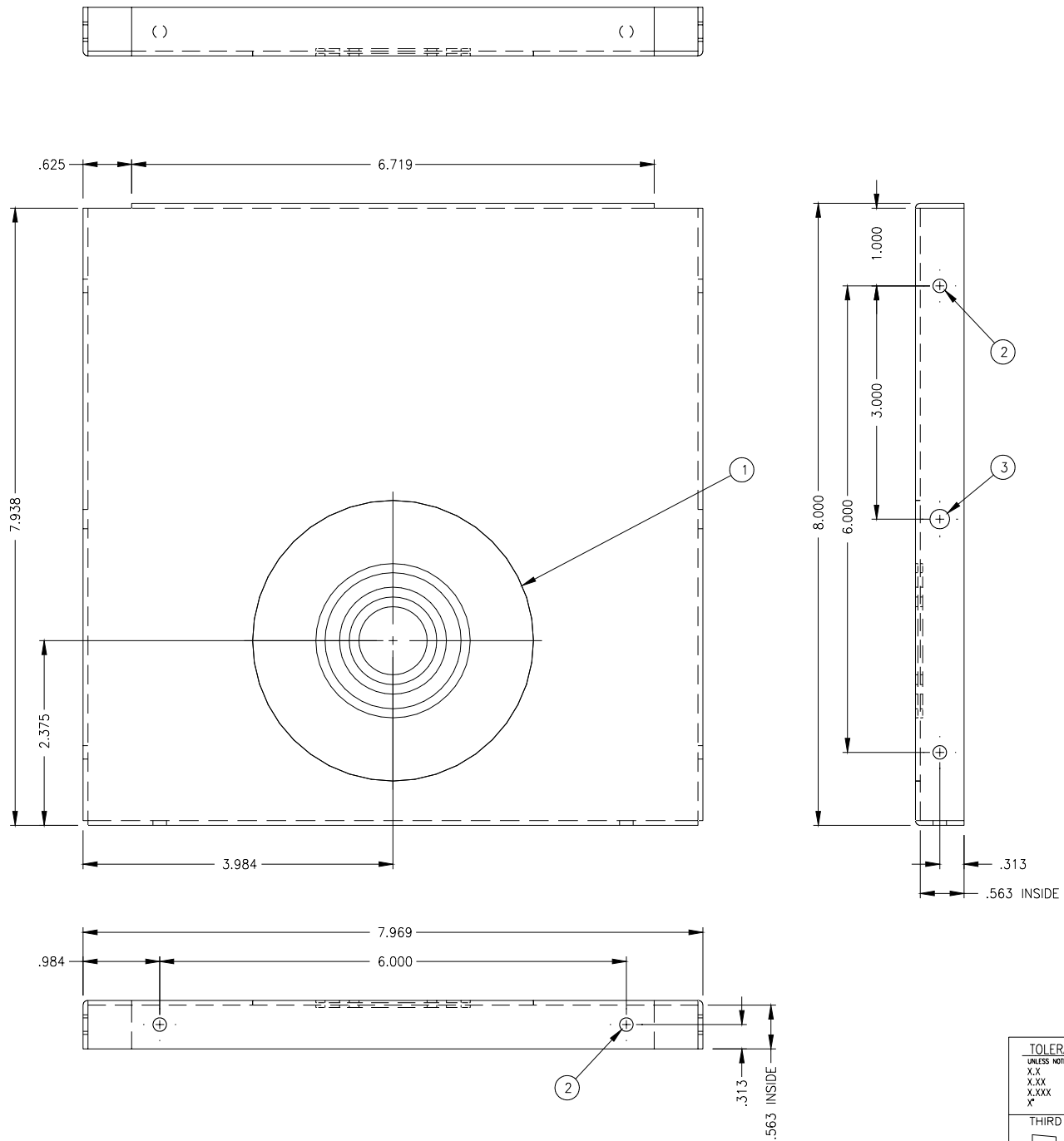

- NOTE:**
- 1. DIE RUN COMPLETE  
KC DIE #2876
  - 2. WHEN SOLD AS "-SSH",  
PACK WITH (2) 913638-SS.

REV.	DATE	DESCRIPTION	BY
H	9-24-98	CHANGE DIE LOCATION ALT #2032	KO
G	8-19-98	ADD HOLE PMR #2201	KO

MATERIAL	16 GA. GALVANIZED
FINISH	PAINTED MILBANK LIGHT GRAY
CATALOG NUMBER	88GE
TITLE	END COVER 8 x 8 GSC1 SCREW COVER WIREWAY

TOLERANCES:	
UNLESS NOTED OTHERWISE	
XX	± .1
X.XX	± .03
X.XXX	± .015
X"	± 2"

THIRD ANGLE		CUSTOMER	
PROJECTION		DRAWING NUMBER	811097-11
DRAWN: SEM	SCALE: NTS	MILBANK MFG. CO.	
CHKD:	DATE: 5-15-90	GENERAL OFFICES KANSAS CITY, MO.	
APPR:			