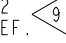
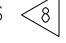
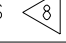
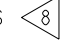

DRAWING NO.  
SD207208-01

CATALOG NO.	WIRE RANGE		L	W	H1	H2 REF. 	NO. OF SCREWS	SCREW DIA.	HEX. SIZE	TORQUE VALUE	FIG. NO.
	MAX.	MIN.									
AMS2	2	14	1.59 [40.5]	.56 [14.3]	.56 [14.3]	.79 [20.1]	2	3/8	S 	50	2
AMS0	1/0	14	1.91 [48.4]	.75 [19.1]	.75 [19.1]	.86 [21.8]	2	7/16	S 	50	2
AMS4/0	4/0	6	2.31 [58.7]	1.00 [25.4]	1.09 [27.8]	1.28 [32.5]	2	5/8	5/16	275	2
AMS250	250	6	4.09 [104.0]	1.00 [25.4]	1.09 [27.8]	1.29 [32.8]	4	5/8	5/16	275	1
AMS350	350	6	4.34 [110.3]	1.00 [25.4]	1.09 [27.8]	1.30 [32.9]	4	11/16	5/16	275	1
AMS500	500	3/0	4.78 [121.4]	1.25 [31.8]	1.38 [34.9]	1.48 [37.7]	4	13/16	3/8	375	1
AMS750	750	250	6.06 [153.9]	1.44 [36.5]	1.63 [41.3]	1.98 [50.4]	4	15/16	1/2	500	1
AMS1000	1000	500	8.69 [220.7]	1.72 [43.7]	1.88 [47.6]	2.34 [59.5]	6	1 1/8	9/16	600	3
AMS2ROHS	2	14	1.59 [40.5]	.56 [14.3]	.56 [14.3]	.79 [20.1]	2	3/8	S 	50	2

REV	DATE	DESCRIPTION	ECO	BY	C'H'K.
B	7/16/2009 12:00:00 AM	REGRAB INTO PRO-E	18262	DG	MA

D

D

C

C

B

B

A

A

REV: PE0200

NOTES:

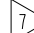
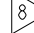
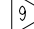
- MATERIAL: ALUMINUM.
- FINISH: TIN-PLATED.
- UL AND CSA LISTED AL9CU.
- CONNECTORS ARE DUAL RATED FOR USE WITH ALUMINUM AND COPPER CONDUCTORS.
- PENETROX™ OXIDE INHIBITING JOINT COMPOUNDS ARE RECOMMENDED FOR ALL ALUMINUM APPLICATIONS. SCRATCH BRUSH CONDUCTOR SURFACE WITH WIRE BRUSH OR EMERY CLOTH PRIOR TO APPLYING PENETROX™.
- DIMENSIONS IN BRACKETS [ ] ARE IN MILLIMETERS.
-  A SOLID CENTER BARRIER PREVENTS CONTACT OF DISSIMILAR METALS.
-  SCREWS ARE SLOTTED.
-  H 2 MEASURED WITH MAX. CONDUCTORS (ONLY REF.)

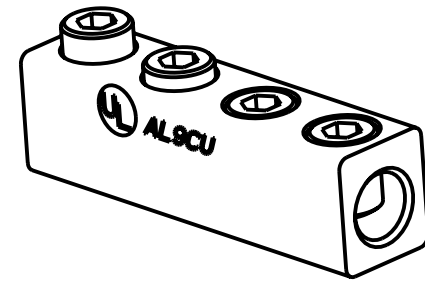
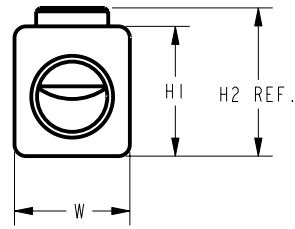
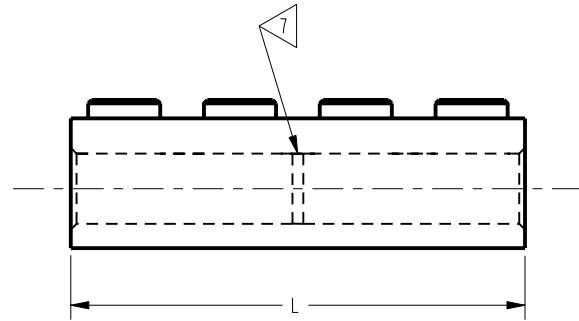

FIG. 1

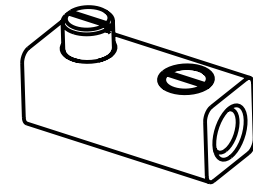

FIG. 2

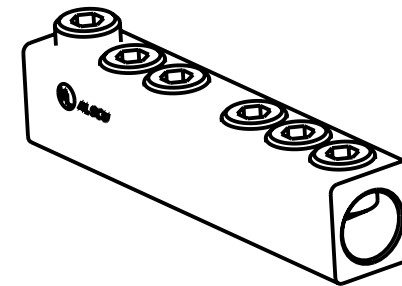

FIG. 3

TO ORDER BURNDY® PRODUCTS CALL		ALUMINUM SPLICE / REDUCER	
UNITED STATES: 1-800-346-4175 (LONDONDERRY, NH)		ITEM NO: N/A	
CANADA: 1-800-361-6975 (QUEBEC) 1-800-387-6487 (ALL OTHER PROVINCES)		CAT. NO: AMS- (TABLE)	
FOR PRODUCT INFO: <a href="http://www.burndy.com">http://www.burndy.com</a>		DRAWN BY: D.FILLION 05/28/1992	
		CHECKER: J.GAUDET 06/29/1992	
		DSN APPVL: C.BLAKE/G.ZAHLMAN 7/1/92	
		MFG APPVL: --	
		QA APPVL: A.LLOYD 07/10/1992	
		MKT APPVL: L.HERRON 07/08/1992	
		SCALE: 2:1	
		PROD FAM: --	
		PROJECT #: --	
		DOCUMENT TYPE: Sales	
		REL LEVEL: Released	
		DRAWING NO: SD207208-01	
		SHEET 1 OF 1	
		REV: B	

4

3

2

1