

# SUPERBAY BALLAST HOUSING

## ORDERING INFORMATION

### SPECIFICATIONS

- Rugged, two-piece, die cast aluminum ballast housing with corrosion resistant Lektrocote® white finish.
- Electrical components are mounted directly to the aluminum housing for cool operation and long life.

### SPECIFICATIONS 150-450 WATT

- Fits with any of fifteen different optical systems.
- Ballasts are high power factor with 180° Class H insulation.

### SPECIFICATIONS 750 WATT PULSE SMART

- Uses new 750 watt Pulse Start lamp.
- Fits with any of SEVEN different optical systems.
- Must use GE lamps: Hubbell #261-0726-9901 clear  
#261-0722-9901 coated

### SPECIFICATIONS 1000 WATT

- Fits with any of four different optical systems.
- Ballasts are high power factor with 180° Class H insulation.

### LISTINGS

- Superbay ballast housings are certified to UL 1598, CSA 22.2 No. 250.0-00 and tested to 55°C ambient operation.
- 1000 watt Superbay ballast housing is certified to CSA 22.2 (35°C ambient operation).
- Suitable for damp locations.



### ORDERING INFORMATION 150-450 WATT

#### ORDERING EXAMPLE

**BLA - 400 - H - 8 - WH**

Series Wattage Source Voltage Color

#### SERIES

**BLA** Superbay Series

#### WATTAGE

**150** 150 watt Pulse Start MH or HPS  
**175** 175 watt MH or Pulse Start MH  
**200** 200 watt Pulse Start MH only  
**250** 250 watt MH, Pulse Start MH or HPS  
**320** 320 watt Pulse Start MH only  
**350** 350 watt Pulse Start MH or Electro-Reg®  
**400** 400 watt MH, Pulse Start MH, HPS or Electro-Reg®  
**450** 450 watt Pulse Start MH only

#### SOURCE

**H** Metal Halide  
**S** High Pressure Sodium  
**W** Pulse Start Metal Halide  
**E** Electro-Reg® (40°C)

#### VOLTAGE

**1** 120V Electro-Reg®  
**2** 208V Electro-Reg®  
**3** 240V Electro-Reg®  
**4** 277V Electro-Reg®  
**5** 480V Electro-Reg®  
**6** Tri-Tap® - 120/277/347V (not available on Electro-Reg®)  
**7** 600V (isolated secondary only)  
**8** Quad-Tap® (multi-tap) - 120/208/240/277V (not available on Electro-Reg®)  
**F** 347V (single voltage only)

#### COLOR

**WH** White (standard)  
**GR** Gray (optional)

NOTE: MV lamp will operate on MH ballast.

NOTE: Energy Saving Linear Reactor Pulse Start ballast available, consult factory. 277V only)

NOTE: Options must be added as suffix to Catalog Number. Accessories must be ordered separately.

### ORDERING INFORMATION 750 WATT PULSE SMART

#### ORDERING EXAMPLE

**BL - 750 - Q - 4 - LM - WH**

Series Wattage Source Voltage Optics Color

#### SERIES

**BL** Superbay Series

#### WATTAGE

**750** 750 watt Quasi Resonant MH

#### SOURCE

**Q** Quasi Resonant Metal Halide

#### VOLTAGE

**4'** 277V

#### OPTICS

**LM** 29" Lowbay (40°C)  
**SD** 19" Reflector with downlight (55°C)  
**SU** 19" Reflector with uplight (55°C)  
**WA22** 22" Clear Prismatic Acrylic (30°C)  
**CH-OU60** 23" Reflector with uplight (55°C) (requires BL-FLUSH-MT-KIT)  
**WA25** 25" Clear Prismatic Acrylic (35°C)  
**EG** 19" Spun Aluminum Highbay (55°C)

#### COLOR

**WH** White (standard)  
**GR** Gray (optional)

### ORDERING INFORMATION 1000 WATT

#### ORDERING EXAMPLE

**BLA - 1000 - H - 8 - WH**

Series Wattage Source Voltage Color

#### SERIES

**BLA** Superbay Series

#### WATTAGE

**1000** 1000 watt MH, Pulse Start MH or HPS

#### SOURCE

**H** Metal Halide  
**S** High Pressure Sodium  
**W** Pulse Start Metal Halide

#### VOLTAGE

**5** 480V  
**6** Tri-Tap® - 120/277/347V  
**8** Quad-Tap® (multi-tap) - 120/208/240/277V

#### COLOR

**WH** White (standard)  
**GR** Gray (optional)

NOTE: Options must be added as suffix to Catalog Number. Accessories must be ordered separately.

# SUPERBAY BI SERIES

14" ALUMINUM  
REFLECTOR

Cat. #		Approvals
Job	Type	



## APPLICATIONS

- Narrow, medium and wide lighting distributions for applications flexibility.

## SPECIFICATIONS

- Anodal® finished 14" diameter spun aluminum reflector.
- Field adjustable brackets provide narrow, medium and wide lighting distributions.
- Rugged, two-piece, die cast aluminum ballast housing with corrosion-resistant Lektrocote® white finish.
- Unit Pack available, see table below (lamp included in Unit Pack).

## LISTINGS

- Up to 55°C ambient, suitable for damp location, minimum 90°C supply conductors.

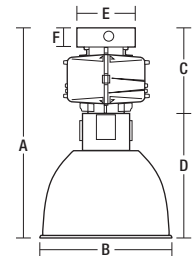

	A	B	C	D	E	F
<b>SLICK-ON®</b>	22 <sup>3</sup> / <sub>16</sub> "-24 <sup>7</sup> / <sub>16</sub> " 564-621 mm	14 <sup>1</sup> / <sub>4</sub> " 362 mm	9 <sup>1</sup> / <sub>2</sub> " 241 mm	9 <sup>7</sup> / <sub>16</sub> " 240 mm	9 <sup>1</sup> / <sub>2</sub> " 241 mm	2" 51 mm
<b>QUICK-ON®</b>	21 <sup>5</sup> / <sub>16</sub> "-23 <sup>9</sup> / <sub>16</sub> " 541-598 mm	14 <sup>1</sup> / <sub>4</sub> " 362 mm	8 <sup>5</sup> / <sub>8</sub> " 219 mm	9 <sup>7</sup> / <sub>16</sub> " 240 mm	9 <sup>1</sup> / <sub>2</sub> " 241 mm	1 <sup>1</sup> / <sub>8</sub> " 29 mm

## ORDERING INFORMATION

### ORDERING EXAMPLE

<b>BL</b>	-	<b>400</b>		<b>P</b>		<b>8</b>	-	<b>BI</b>	-	<b>WH</b>
Series		Wattage		Source		Voltage		Optics		Color

### SERIES

**BL** Superbay Series

### WATTAGE

<b>150</b>	150 watt HPS
<b>175</b>	175 watt MH or Pulse Start MH
<b>200</b>	200 watt Pulse Start MH only
<b>250</b>	250 watt MH, Pulse Start MH or HPS
<b>320</b>	320 watt Pulse Start MH only
<b>350</b>	350 watt Pulse Start MH or Electro-Reg®
<b>400</b>	400 watt MH, Pulse Start MH, HPS or Electro-Reg®
<b>450</b>	450 watt Pulse Start MH only

### SOURCE

<b>H</b>	Metal Halide (export only)
<b>S</b>	High Pressure Sodium
<b>P</b>	Pulse Start Metal Halide
<b>E</b>	Electro-Reg® (40°C)

### VOLTAGE

<b>1</b>	120V Electro-Reg®
<b>2</b>	208V Electro-Reg®
<b>3</b>	240V Electro-Reg®
<b>4</b>	277V Electro-Reg®
<b>5</b>	480V
<b>6</b>	Tri-Tap® - 120/277/347V
<b>7</b>	600V (isolated secondary only)
<b>8</b>	Quad-Tap® (multi-tap) - 120/208/240/277V
<b>F</b>	347V

### OPTICS

**BI** 14" Spun Aluminum Highbay Reflector with uplight

### BOTTOM ENCLOSURE

**BL-LR-14** Bottom Enclosure

### COLOR

**WH** White (standard)  
**GR** Gray (optional)

NOTE: MV lamp will operate on MH ballast.

NOTE: Energy Saving Linear Reactor Pulse Start ballast available, consult factory (277V only).

NOTE: Bottom enclosures are required unless lamps designated as "suitable for open use" are used.

NOTE: Options must be added as suffix to Catalog Number. Accessories must be ordered separately.

## BI UNIT PACKS

MATERIAL	MATERIAL DESCRIPTION	WATTAGE	VOLTAGE	LAMP BASE	LAMP INCLUDED
<b>METAL HALIDE PULSE START</b>					
BL320P8BCEXUPL	BL-320P8-BC-WH-EX-UPL	320	Quad-Tap	Exclusionary	Lamp Included
BL320P8BCWHUPL	BL-320P8-BC-WH-UPL	320	Quad-Tap	Mogul	Lamp Included
BL400P8BCEXUPL	BL-400P8-BC-WH-EX-UPL	400	Quad-Tap	Exclusionary	Lamp Included
BL400P8BCWHUPL	BL-400P8-BC-WH-UPL	400	Quad-Tap	Mogul	Lamp Included
<b>HIGH PRESSURE SODIUM</b>					
BL400S8WHBIUPL	BL-400S8-WH-BI-UPL	400	Quad-Tap	Mogul	Lamp Included