

# Weatherproof metallic covers

## Universal flip-lid weatherproof covers

### Single-gang covers

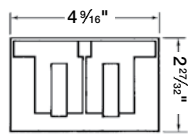

CCD

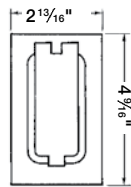

CCDV & CCGV

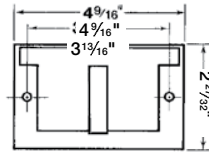

CCG

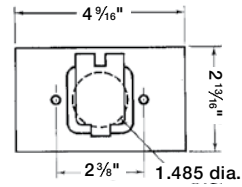

CCS

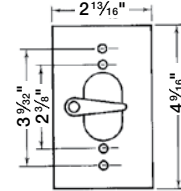

CCT

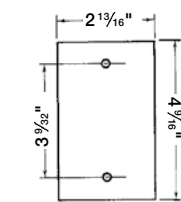

CCB

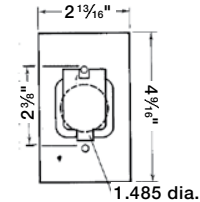

CCSV

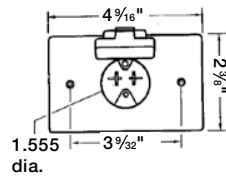

CCMB

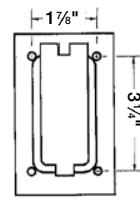

Typical FS mount hole pattern

### Two- and three-gang covers

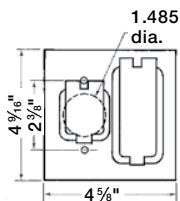

2CCSD & 2CCSG

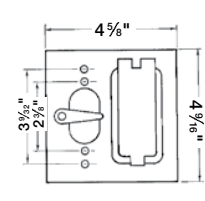

2CCTD

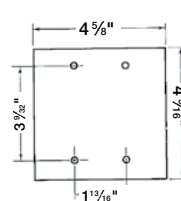

2CCB

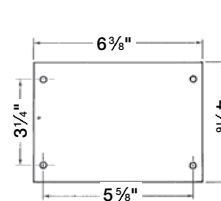

3CCB

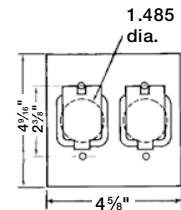

2CCS

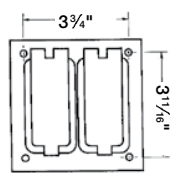

2CCD & 2CCG

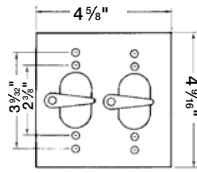

2CCT

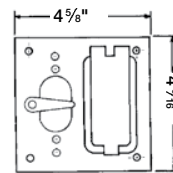

2CCTG-FS

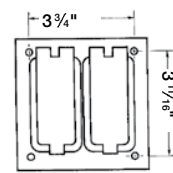

Typical FS mount hole pattern

# Weatherproof metallic covers

## Universal flip-lid weatherproof covers

### Single-gang covers

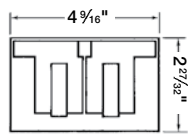

CCD

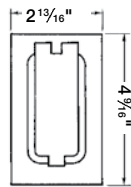

CCDV & CCGV

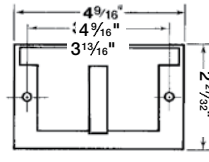

CCG

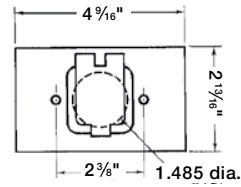

CCS

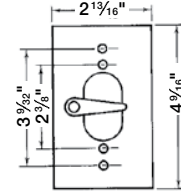

CCT

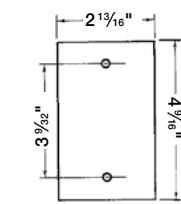

CCB

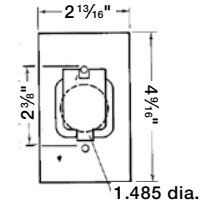

CCSV

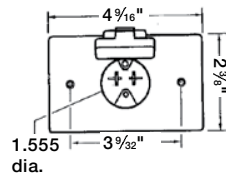

CCMB

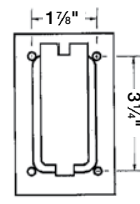

Typical FS mount hole pattern

### Two- and three-gang covers

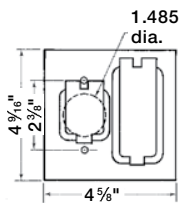

2CCSD & 2CCSG

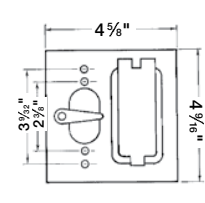

2CCTD

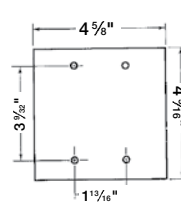

2CCB

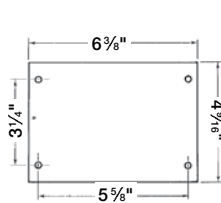

3CCB

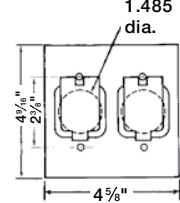

2CCS

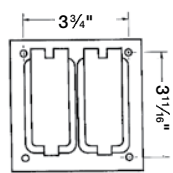

2CCD & 2CCG

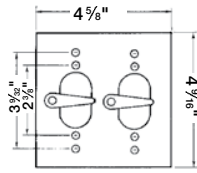

2CCT

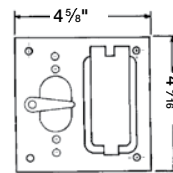

2CCTG-FS

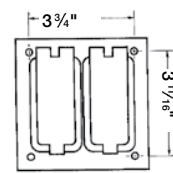

Typical FS mount hole pattern