

## Nylon Insulated Female Disconnects

Drawn - SD

Approved - KM

Material - Brass / Nylon Insulation

Title - Nylon Insulated Female Disconnects

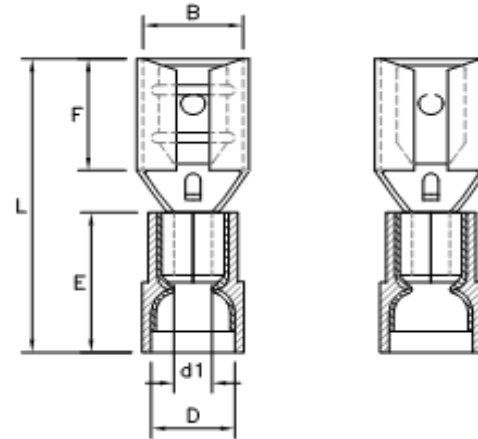

Part Number	Wire Range	Insulated Color	Electrical Rating Max	B	F	L	E	D	d1
F22-110-2N	22-18 AWG	RED	105C / 600V	0.163	0.250	0.789	0.430	0.115	0.072
F22-110-3N	22-18 AWG	RED	105C / 600V	0.163	0.250	0.789	0.430	0.115	0.072
F22-187-2N	22-18 AWG	RED	105C / 600V	0.238	0.250	0.789	0.430	0.115	0.072
F22-187-3N	22-18 AWG	RED	105C / 600V	0.238	0.250	0.789	0.430	0.115	0.072
F22-250-3N	22-18 AWG	RED	105C / 600V	0.260	0.311	0.866	0.433	0.161	0.067
F16-110-2N	16-14 AWG	BLUE	105C / 600V	0.163	0.250	0.789	0.430	0.138	0.090
F16-110-3N	16-14 AWG	BLUE	105C / 600V	0.163	0.250	0.789	0.430	0.138	0.090
F16-187-2N	16-14 AWG	BLUE	105C / 600V	0.163	0.250	0.789	0.430	0.138	0.090
F16-187-3N	16-14 AWG	BLUE	105C / 600V	0.197	0.256	0.787	0.433	0.189	0.091
F16-250-3N	16-14 AWG	BLUE	105C / 600V	0.260	0.311	0.866	0.433	0.189	0.091
F12-250-3N	12-10 AWG	YELLOW	105C / 600V	0.260	0.311	0.945	0.512	0.256	0.134

## Nylon Insulated Female Disconnects

Drawn - SD

Approved - KM

Material - Brass / Nylon Insulation

Title - Nylon Insulated Female Disconnects

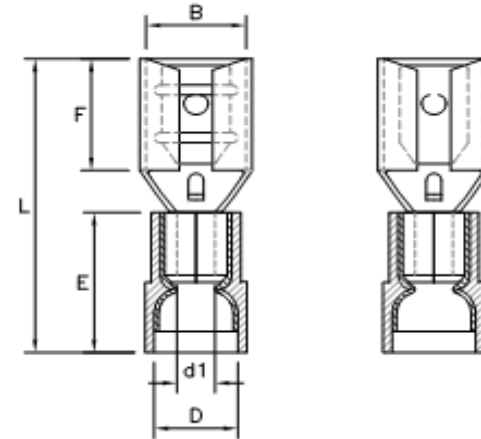

Part Number	Wire Range	Insulated Color	Electrical Rating Max	B	F	L	E	D	d1
F22-110-2N	22-18 AWG	RED	105C / 600V	0.163	0.250	0.789	0.430	0.115	0.072
F22-110-3N	22-18 AWG	RED	105C / 600V	0.163	0.250	0.789	0.430	0.115	0.072
F22-187-2N	22-18 AWG	RED	105C / 600V	0.238	0.250	0.789	0.430	0.115	0.072
F22-187-3N	22-18 AWG	RED	105C / 600V	0.238	0.250	0.789	0.430	0.115	0.072
F22-250-3N	22-18 AWG	RED	105C / 600V	0.260	0.311	0.866	0.433	0.161	0.067
F16-110-2N	16-14 AWG	BLUE	105C / 600V	0.163	0.250	0.789	0.430	0.138	0.090
F16-110-3N	16-14 AWG	BLUE	105C / 600V	0.163	0.250	0.789	0.430	0.138	0.090
F16-187-2N	16-14 AWG	BLUE	105C / 600V	0.163	0.250	0.789	0.430	0.138	0.090
F16-187-3N	16-14 AWG	BLUE	105C / 600V	0.197	0.256	0.787	0.433	0.189	0.091
F16-250-3N	16-14 AWG	BLUE	105C / 600V	0.260	0.311	0.866	0.433	0.189	0.091
F12-250-3N	12-10 AWG	YELLOW	105C / 600V	0.260	0.311	0.945	0.512	0.256	0.134