

# GRU Universal Conduit Outlet Boxes

## Explosionproof, Dust-Ignitionproof

UNILETS® for use with Threaded Metal Conduit. Furnished with Internal Ground Screw. Furnished with O-Ring.

Class I, Division 1 and 2, Groups C, D  
 Class II, Division 1 and 2, Groups E, F, G  
 Class III

Enclosures and Junction Boxes

ENCLOSURES AND JUNCTION BOXES: HAZARDOUS LOCATION CONDUIT OUTLET BOXES

### Applications

- Complies with a wide range of classified area requirements.
- Corrosion-resistant: ideal indoors or out.
- For pulling of wires.
- Connect conduit lengths and change direction of conduit runs.
- Provide access for maintenance.

### Features

- Accurately tapped, tapered hub threads for tight, rigid joints and ground continuity.
- Furnished with covers.
- General purpose wiring.
- Universal design with five threaded universal hubs and three close-up plugs.
- Copperfree aluminum body and cover provide resistance to corrosive atmospheres.
- Internally threaded body and externally threaded cover with O-ring for raintight fit, NEMA 3, 4.
- Covers have pry notches for bar or wrench.
- Smooth, rounded integral bushing in each hub type box protects conductor insulation.

### Standard Materials

- Bodies and covers: copperfree (4/10 of 1% max.) aluminum

### Standard Finishes

- Bodies and covers: epoxy powder coat

### Certifications and Compliances

- UL Standard: UL 886 (UL 1203)
- UL Listed: E10444
- CSA Standard: C22.2 No. 25, C22.2 No. 30
- CSA Certified: 025875

Furnished with externally threaded aluminum surface cover, O-Ring, five threaded hubs, and three close-up plugs.  
 For Form numbers designate body and matching cover sizes.

	Conduit Size (Inches)	Cover Body Opening Inches/Millimeters	Capacity in <sup>3</sup> /dm <sup>3</sup>	Form Number	Catalog Number
	1/2	3.38/85.9	13.5/0.22	1	GRU50-A
	3/4	3.38/85.9	13.5/0.22	1	GRU75-A
	1	3.38/85.9	17.5/0.29	1	GRU100-A *

### Dimensions

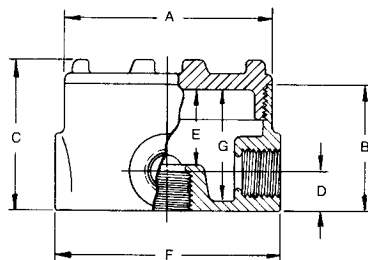

Hub Size Inches	Dimensions in Inches/Millimeters						
	A	B	C	D	E	F	G
1/2	3.75/95.3	2.25/57.2	2.69/68.3	0.69/17.5	1.38/35.1	4.06/103.1	2.00/50.8
3/4	3.75/95.3	2.25/57.2	2.69/68.3	0.69/17.5	1.38/35.1	4.06/103.1	2.00/50.8
1	3.75/95.3	2.44/62.0	2.88/73.2	0.94/23.9	1.44/36.6	5.44/138.2	2.19/55.6

\* Not CSA Certified.

# GRU Universal Conduit Outlet Boxes

## Explosionproof, Dust-Ignitionproof

UNILETS® for use with Threaded Metal Conduit. Furnished with Internal Ground Screw. Furnished with O-Ring.

Class I, Division 1 and 2, Groups C, D  
 Class II, Division 1 and 2, Groups E, F, G  
 Class III

Enclosures and Junction Boxes

ENCLOSURES AND JUNCTION BOXES: HAZARDOUS LOCATION CONDUIT OUTLET BOXES

### Applications

- Complies with a wide range of classified area requirements.
- Corrosion-resistant: ideal indoors or out.
- For pulling of wires.
- Connect conduit lengths and change direction of conduit runs.
- Provide access for maintenance.

### Features

- Accurately tapped, tapered hub threads for tight, rigid joints and ground continuity.
- Furnished with covers.
- General purpose wiring.
- Universal design with five threaded universal hubs and three close-up plugs.
- Copperfree aluminum body and cover provide resistance to corrosive atmospheres.
- Internally threaded body and externally threaded cover with O-ring for raintight fit, NEMA 3, 4.
- Covers have pry notches for bar or wrench.
- Smooth, rounded integral bushing in each hub type box protects conductor insulation.

### Standard Materials

- Bodies and covers: copperfree (4/10 of 1% max.) aluminum

### Standard Finishes

- Bodies and covers: epoxy powder coat

### Certifications and Compliances

- UL Standard: UL 886 (UL 1203)
- UL Listed: E10444
- CSA Standard: C22.2 No. 25, C22.2 No. 30
- CSA Certified: 025875

Furnished with externally threaded aluminum surface cover, O-Ring, five threaded hubs, and three close-up plugs.  
 For Form numbers designate body and matching cover sizes.

	Conduit Size (Inches)	Cover Body Opening Inches/Millimeters	Capacity in <sup>3</sup> /dm <sup>3</sup>	Form Number	Catalog Number
	1/2	3.38/85.9	13.5/0.22	1	GRU50-A
	3/4	3.38/85.9	13.5/0.22	1	GRU75-A
	1	3.38/85.9	17.5/0.29	1	GRU100-A *

### Dimensions

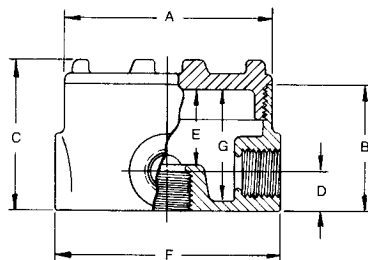

Hub Size Inches	Dimensions in Inches/Millimeters						
	A	B	C	D	E	F	G
1/2	3.75/95.3	2.25/57.2	2.69/68.3	0.69/17.5	1.38/35.1	4.06/103.1	2.00/50.8
3/4	3.75/95.3	2.25/57.2	2.69/68.3	0.69/17.5	1.38/35.1	4.06/103.1	2.00/50.8
1	3.75/95.3	2.44/62.0	2.88/73.2	0.94/23.9	1.44/36.6	5.44/138.2	2.19/55.6

\* Not CSA Certified.