



Wet Location

ILW48LED4D 4' Industrial LED Wet Location



SPECIFICATIONS:

Lumens: 6,628
Watts: 47.87
Lumens/Watt: 139.5
CRI: 83
CCT: 4471
Lifespan: 200,000+ hrs.¹

Construction:

The 1-piece housing is made of durable composite material with 1/2" entry points on both ends. The poured gasket provides a continuous seal for the lens. Eight polycarbonate cam latches compress lens to housing for a tight seal. Stainless steel mounting brackets are furnished with each fixture.

Lens:

Injection molded acrylic lens with high impact additive. Lens is ribbed and frosted to eliminate glare.

Listings:

Luminaire is certified to UL/cUL Standards for Wet Locations DesignLights Consortium Premium qualified luminaire, eligible for rebates from DLC member utilities.
 DLC Product ID: P4KJAYFA

AC Input:

120/208/240/277 V

Driver:

Constant current, Class 2 120-277 VAC, 47-63Hz
 High Efficiency – min. 85%
 Off-State Power: 0 Watts
 0-10V Dimming

LEDs:

Atlas LEDs provide higher lumen output, greater energy efficiency and more reliable fixture performance. LEDs manufactured for the ILW series utilize Epoxy Guard conformal coating which reduces the chance of board corrosion. ILW series fixtures operate at 4500K CCT

Temperatures:

Min Start: -40°C Max: 40°C

Ratings:

NEMA4X
 IP65, IP66 & IP67
 NSF
 1500 PSI Hose Down

Installation:

Fixture retains the same knock-out sizes and positions as previous models, reducing wiring costs. Mounting bracket allows unit to be hung with aircraft cable.

Applications:

Cold storage, garages, refrigerated cases, stairwells, storage areas, fuel pump canopy, low-bay fixtures for commercial & industrial buildings.

Testing:

Atlas LED luminaires have been tested by an independent laboratory in accordance with IESNA LM-79 & LM-80.

Warranty:

Five-year limited warranty

Emergency Back-up: For factory installed Emergency Back-Up add suffix EB to part number.

480 Volt: For 480V add suffix 4 to part number.

Options: L = Stainless Steel Latches, 3C = 3' Cord, 6C = 6' Cord

Weight: 9.5 lbs

Project Information

Job Name

Fixture Type 4' Industrial LED Wet Location

Catalog Number ILW48LED4D

Approved by

NEMA 4X



DIMENSIONS:

Patent Pending

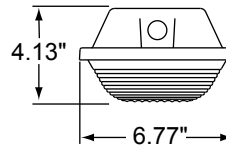
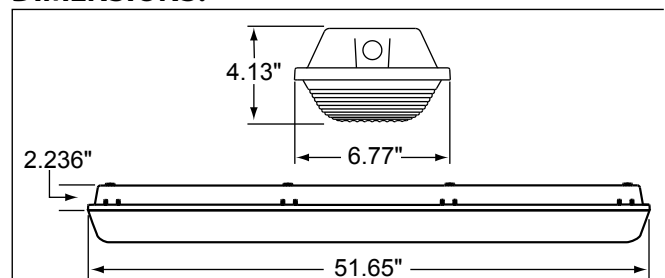

2.236"

4.13"

6.77"

51.65"

¹LED Life Span Based Upon LM-80 Test Results

**Rebates and Incentives are available in many areas.
 Contact an Atlas Representative for more information.**

ATLAS LIGHTING PRODUCTS, INC.

PO BOX 2348 | BURLINGTON, NC 27216
 800-849-8485 | FAX: 336-227-0110 | www.atlaslightingproducts.com

*The majority of Atlas Lighting Products are assembled in USA facilities by an American Workforce utilizing both Domestic and Foreign components. Meets Buy American requirements within the ARRA.



Wet Location

ILW48LED4D 4' Industrial LED Wet Location

IP RATING

	DESCRIPTION	DEFINITION
6	Dust-tight	No ingress of dust
5	Protects against water jets	Water projected from a nozzle against the enclosure from any direction shall have no harmful effect
6	Dust-tight	No ingress of dust
6	Protects against powerful water jets	Water projected in powerful jets against the enclosure from any direction shall have no harmful effect
6	Dust-tight	No ingress of dust
7	Protects against the effects of immersion	Ingress of water in a harmful quantity shall not be possible when the enclosure is immersed in water under defined conditions of pressure & time

ATLAS LIGHTING PRODUCTS, INC.

PO BOX 2348 | BURLINGTON, NC 27216
800-849-8485 | FAX: 336-227-0110 | www.atlaslightingproducts.com

The majority of Atlas Lighting Products are assembled in USA facilities by an American Workforce utilizing both Domestic and Foreign components. Meets Buy American requirements within the ARRA.



Wet Location

ILW48LED4D 4' Industrial LED Wet Location



SPECIFICATIONS:

Lumens: 6,628
Watts: 47.87
Lumens/Watt: 139.5
CRI: 83
CCT: 4471
Lifespan: 200,000+ hrs.¹

Construction:

The 1-piece housing is made of durable composite material with 1/2" entry points on both ends. The poured gasket provides a continuous seal for the lens. Eight polycarbonate cam latches compress lens to housing for a tight seal. Stainless steel mounting brackets are furnished with each fixture.

Lens:

Injection molded acrylic lens with high impact additive. Lens is ribbed and frosted to eliminate glare.

Listings:

Luminaire is certified to UL/cUL Standards for Wet Locations DesignLights Consortium Premium qualified luminaire, eligible for rebates from DLC member utilities.
 DLC Product ID: P4KJAYFA

AC Input:

120/208/240/277 V

Driver:

Constant current, Class 2 120-277 VAC, 47-63Hz
 High Efficiency – min. 85%
 Off-State Power: 0 Watts
 0-10V Dimming

LEDs:

Atlas LEDs provide higher lumen output, greater energy efficiency and more reliable fixture performance. LEDs manufactured for the ILW series utilize Epoxy Guard conformal coating which reduces the chance of board corrosion. ILW series fixtures operate at 4500K CCT

Temperatures:

Min Start: -40°C Max: 40°C

Ratings:

NEMA4X
 IP65, IP66 & IP67
 NSF
 1500 PSI Hose Down

Installation:

Fixture retains the same knock-out sizes and positions as previous models, reducing wiring costs. Mounting bracket allows unit to be hung with aircraft cable.

Applications:

Cold storage, garages, refrigerated cases, stairwells, storage areas, fuel pump canopy, low-bay fixtures for commercial & industrial buildings.

Testing:

Atlas LED luminaires have been tested by an independent laboratory in accordance with IESNA LM-79 & LM-80.

Warranty:

Five-year limited warranty

Emergency Back-up:

For factory installed Emergency Back-Up add suffix EB to part number.

480 Volt:

For 480V add suffix 4 to part number.

Options:

L = Stainless Steel Latches, 3C = 3' Cord, 6C = 6' Cord

Weight:

9.5 lbs

Project Information

Job Name

Fixture Type 4' Industrial LED Wet Location

Catalog Number ILW48LED4D

Approved by

NEMA 4X



DIMENSIONS:

Patent Pending

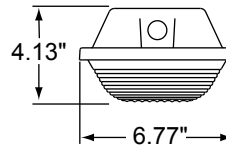
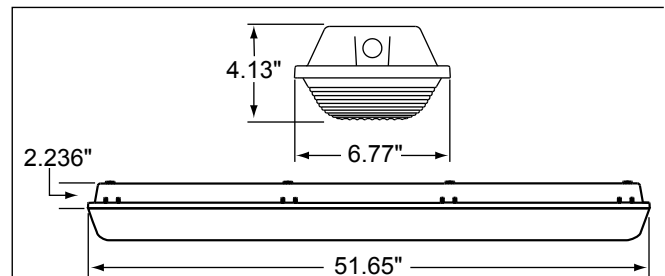

2.236"

4.13"

6.77"

51.65"

¹LED Life Span Based Upon LM-80 Test Results

**Rebates and Incentives are available in many areas.
 Contact an Atlas Representative for more information.**

ATLAS LIGHTING PRODUCTS, INC.

PO BOX 2348 | BURLINGTON, NC 27216
 800-849-8485 | FAX: 336-227-0110 | www.atlaslightingproducts.com

*The majority of Atlas Lighting Products are assembled in USA facilities by an American Workforce utilizing both Domestic and Foreign components. Meets Buy American requirements within the ARRA.

IP RATING

	DESCRIPTION	DEFINITION
6	Dust-tight	No ingress of dust
5	Protects against water jets	Water projected from a nozzle against the enclosure from any direction shall have no harmful effect
6	Dust-tight	No ingress of dust
6	Protects against powerful water jets	Water projected in powerful jets against the enclosure from any direction shall have no harmful effect
6	Dust-tight	No ingress of dust
7	Protects against the effects of immersion	Ingress of water in a harmful quantity shall not be possible when the enclosure is immersed in water under defined conditions of pressure & time