

# CONNECTORS

## Compression Connectors

### Long Barrel One Hole Copper Lugs

#### L Series Cont'd



#### FEATURES

- Produced from high conductivity copper tubing.
- Tin-plated to provide corrosion low contact resistance.
- Marked with die index and color coded.
- Listed for 35KV max when properly installed and to cable manufacturer instructions.
- For applications greater than 2000V, consult the cable Manufacturer for voltage stress relief instructions.
- **Part Numbers ending in "P" have a "peep" or sight inspection hole.**

#### SPECIFICATIONS

- UL486A Listed Wire Connector.
- UL467 Grounding & Bonding (Sizes 8 AWG - 3/0 AWG).
- Max ampacity is based on NEC 310.15, insulation type, and conductor material. Please consult your current NEC manual.
- \* CLASS B OR C BUILDING WIRE CU CABLE ONLY.
- Temperature Rating: 90 °C.
- Voltage: 600V

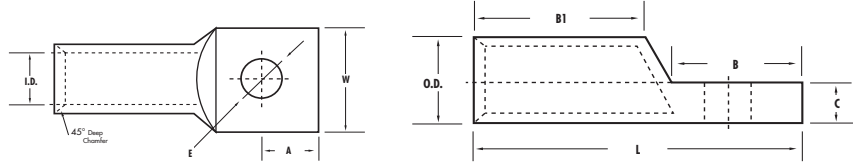

**\*EXPANDED WIRE RANGE** when installed with NSI N12ID dieless compression tool.  
 UL Listed with other tools:  
**FOR TOOL/DIE CRIMPING INFORMATION, PLEASE SEE TABLE ON PAGE 87**

| CAT. NO. | WIRE RANGE | EXPANDED WIRE RANGE** | BOLT SIZE (IN.) | BARREL I.D. | BARREL O.D. | LENGTH (L) (IN.) | WIDTH (W) (IN.) | A (IN.) | B (IN.) | B1 (IN.) | C (IN.) | E (IN.) | COLOR | STD. CTN. QTY. |
|----------|------------|-----------------------|-----------------|-------------|-------------|------------------|-----------------|---------|---------|----------|---------|---------|-------|----------------|
| L356     | 3 AWG      | 3 - 6 AWG             | 5/16"           | 0.270       | 0.377       | 2.157            | 0.538           | 0.346   | 0.767   | 1.120    | 0.091   | 0.336   | White | 50             |
| L338     | 3 AWG      | 3 - 6 AWG             | 3/8"            | 0.270       | 0.377       | 2.351            | 0.550           | 0.418   | 0.823   | 1.188    | 0.083   | 0.397   | White | 50             |
| L214     | 2 AWG      | 2 - 6 AWG             | 1/4"            | 0.315       | 0.421       | 2.071            | 0.602           | 0.206   | 0.811   | 1.102    | 0.102   | 0.252   | Brown | 50             |
| L214P    | 2 AWG      | 2 - 6 AWG             | 1/4"            | 0.315       | 0.421       | 2.071            | 0.602           | 0.206   | 0.811   | 1.102    | 0.102   | 0.252   | Brown | 50             |
| L256     | 2 AWG      | 2 - 6 AWG             | 5/16"           | 0.315       | 0.421       | 2.071            | 0.602           | 0.370   | 0.811   | 1.102    | 0.102   | 0.331   | Brown | 50             |
| L256P    | 2 AWG      | 2 - 6 AWG             | 5/16"           | 0.315       | 0.421       | 2.071            | 0.602           | 0.370   | 0.811   | 1.102    | 0.102   | 0.331   | Brown | 50             |
| L238     | 2 AWG      | 2 - 6 AWG             | 3/8"            | 0.315       | 0.421       | 2.071            | 0.602           | 0.370   | 0.811   | 1.102    | 0.102   | 0.413   | Brown | 50             |
| L238P    | 2 AWG      | 2 - 6 AWG             | 3/8"            | 0.315       | 0.421       | 2.071            | 0.602           | 0.370   | 0.811   | 1.102    | 0.102   | 0.413   | Brown | 50             |
| L156     | 1 AWG      | 1 - 6 AWG             | 5/16"           | 0.358       | 0.469       | 2.110            | 0.673           | 0.370   | 0.811   | 1.102    | 0.106   | 0.331   | Green | 50             |
| L138     | 1 AWG      | 1 - 6 AWG             | 3/8"            | 0.358       | 0.469       | 2.209            | 0.673           | 0.370   | 0.811   | 1.102    | 0.106   | 0.413   | Green | 50             |
| L1014    | 1/0 AWG    | 1/0 - 6 AWG           | 1/4"            | 0.390       | 0.520       | 2.210            | 0.744           | 0.370   | 0.811   | 1.201    | 0.126   | 0.210   | Pink  | 50             |
| L1014P   | 1/0 AWG    | 1/0 - 6 AWG           | 1/4"            | 0.390       | 0.520       | 2.210            | 0.744           | 0.370   | 0.811   | 1.201    | 0.126   | 0.210   | Pink  | 50             |
| L1038    | 1/0 AWG    | 1/0 - 6 AWG           | 3/8"            | 0.390       | 0.520       | 2.209            | 0.744           | 0.370   | 0.811   | 1.201    | 0.126   | 0.413   | Pink  | 50             |
| L1038P   | 1/0 AWG    | 1/0 - 6 AWG           | 3/8"            | 0.390       | 0.520       | 2.209            | 0.744           | 0.370   | 0.811   | 1.201    | 0.126   | 0.413   | Pink  | 50             |
| L1056    | 1/0 AWG    | 1/0 - 6 AWG           | 5/16"           | 0.390       | 0.520       | 2.210            | 0.744           | 0.370   | 0.811   | 1.201    | 0.126   | 0.330   | Pink  | 50             |
| L1056P   | 1/0 AWG    | 1/0 - 6 AWG           | 5/16"           | 0.390       | 0.520       | 2.210            | 0.744           | 0.370   | 0.811   | 1.201    | 0.126   | 0.330   | Pink  | 50             |
| L1048    | 1/0 AWG    | 1/0 - 6 AWG           | 1/2"            | 0.390       | 0.520       | 2.500            | 0.744           | 0.472   | 1.063   | 1.201    | 0.126   | 0.512   | Pink  | 50             |
| L2014    | 2/0 AWG    | 2/0 - 4 AWG           | 1/4"            | 0.441       | 0.563       | 2.677            | 0.815           | 0.472   | 1.063   | 1.378    | 0.118   | 0.252   | Black | 25             |
| L2014P   | 2/0 AWG    | 2/0 - 4 AWG           | 1/4"            | 0.441       | 0.563       | 2.677            | 0.815           | 0.472   | 1.063   | 1.378    | 0.118   | 0.252   | Black | 25             |
| L2038    | 2/0 AWG    | 2/0 - 4 AWG           | 3/8"            | 0.441       | 0.563       | 2.677            | 0.815           | 0.472   | 1.063   | 1.378    | 0.118   | 0.413   | Black | 25             |
| L2038P   | 2/0 AWG    | 2/0 - 4 AWG           | 3/8"            | 0.441       | 0.563       | 2.677            | 0.815           | 0.472   | 1.063   | 1.378    | 0.118   | 0.413   | Black | 25             |
| L2048    | 2/0 AWG    | 2/0 - 4 AWG           | 1/2"            | 0.441       | 0.563       | 2.677            | 0.815           | 0.472   | 1.063   | 1.378    | 0.118   | 0.512   | Black | 25             |

# CONNECTORS

## Compression Connectors

### Long Barrel One Hole Copper Lugs

#### L Series Cont'd



#### FEATURES

- Produced from high conductivity copper tubing.
- Tin-plated to provide corrosion low contact resistance.
- Marked with die index and color coded.
- Listed for 35KV max when properly installed and to cable manufacturer instructions.
- For applications greater than 2000V, consult the cable Manufacturer for voltage stress relief instructions.
- **Part Numbers ending in "P" have a "peep" or sight inspection hole.**

#### SPECIFICATIONS

- UL486A Listed Wire Connector.
- UL467 Grounding & Bonding (Sizes 8 AWG - 3/0 AWG).
- Max ampacity is based on NEC 310.15, insulation type, and conductor material. Please consult your current NEC manual.
- \* CLASS B OR C BUILDING WIRE CU CABLE ONLY.
- Temperature Rating: 90 °C.
- Voltage: 600V

CONNECTORS

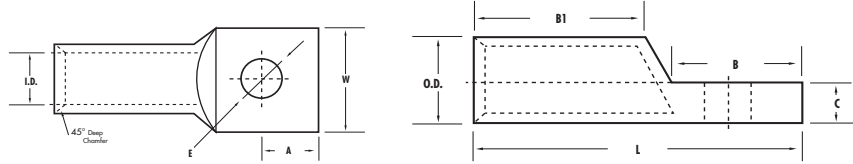

**\*EXPANDED WIRE RANGE** when installed with NSI N12ID dieless compression tool.  
 UL Listed with other tools:  
**FOR TOOL/DIE CRIMPING INFORMATION, PLEASE SEE TABLE ON PAGE 87**

| CAT. NO. | WIRE RANGE | EXPANDED WIRE RANGE** | BOLT SIZE (IN.) | BARREL I.D. | BARREL O.D. | LENGTH (L) (IN.) | WIDTH (W) (IN.) | A (IN.) | B (IN.) | B1 (IN.) | C (IN.) | E (IN.) | COLOR | STD. CTN. QTY. |
|----------|------------|-----------------------|-----------------|-------------|-------------|------------------|-----------------|---------|---------|----------|---------|---------|-------|----------------|
| L356     | 3 AWG      | 3 - 6 AWG             | 5/16"           | 0.270       | 0.377       | 2.157            | 0.538           | 0.346   | 0.767   | 1.120    | 0.091   | 0.336   | White | 50             |
| L338     | 3 AWG      | 3 - 6 AWG             | 3/8"            | 0.270       | 0.377       | 2.351            | 0.550           | 0.418   | 0.823   | 1.188    | 0.083   | 0.397   | White | 50             |
| L214     | 2 AWG      | 2 - 6 AWG             | 1/4"            | 0.315       | 0.421       | 2.071            | 0.602           | 0.206   | 0.811   | 1.102    | 0.102   | 0.252   | Brown | 50             |
| L214P    | 2 AWG      | 2 - 6 AWG             | 1/4"            | 0.315       | 0.421       | 2.071            | 0.602           | 0.206   | 0.811   | 1.102    | 0.102   | 0.252   | Brown | 50             |
| L256     | 2 AWG      | 2 - 6 AWG             | 5/16"           | 0.315       | 0.421       | 2.071            | 0.602           | 0.370   | 0.811   | 1.102    | 0.102   | 0.331   | Brown | 50             |
| L256P    | 2 AWG      | 2 - 6 AWG             | 5/16"           | 0.315       | 0.421       | 2.071            | 0.602           | 0.370   | 0.811   | 1.102    | 0.102   | 0.331   | Brown | 50             |
| L238     | 2 AWG      | 2 - 6 AWG             | 3/8"            | 0.315       | 0.421       | 2.071            | 0.602           | 0.370   | 0.811   | 1.102    | 0.102   | 0.413   | Brown | 50             |
| L238P    | 2 AWG      | 2 - 6 AWG             | 3/8"            | 0.315       | 0.421       | 2.071            | 0.602           | 0.370   | 0.811   | 1.102    | 0.102   | 0.413   | Brown | 50             |
| L156     | 1 AWG      | 1 - 6 AWG             | 5/16"           | 0.358       | 0.469       | 2.110            | 0.673           | 0.370   | 0.811   | 1.102    | 0.106   | 0.331   | Green | 50             |
| L138     | 1 AWG      | 1 - 6 AWG             | 3/8"            | 0.358       | 0.469       | 2.209            | 0.673           | 0.370   | 0.811   | 1.102    | 0.106   | 0.413   | Green | 50             |
| L1014    | 1/0 AWG    | 1/0 - 6 AWG           | 1/4"            | 0.390       | 0.520       | 2.210            | 0.744           | 0.370   | 0.811   | 1.201    | 0.126   | 0.210   | Pink  | 50             |
| L1014P   | 1/0 AWG    | 1/0 - 6 AWG           | 1/4"            | 0.390       | 0.520       | 2.210            | 0.744           | 0.370   | 0.811   | 1.201    | 0.126   | 0.210   | Pink  | 50             |
| L1038    | 1/0 AWG    | 1/0 - 6 AWG           | 3/8"            | 0.390       | 0.520       | 2.209            | 0.744           | 0.370   | 0.811   | 1.201    | 0.126   | 0.413   | Pink  | 50             |
| L1038P   | 1/0 AWG    | 1/0 - 6 AWG           | 3/8"            | 0.390       | 0.520       | 2.209            | 0.744           | 0.370   | 0.811   | 1.201    | 0.126   | 0.413   | Pink  | 50             |
| L1056    | 1/0 AWG    | 1/0 - 6 AWG           | 5/16"           | 0.390       | 0.520       | 2.210            | 0.744           | 0.370   | 0.811   | 1.201    | 0.126   | 0.330   | Pink  | 50             |
| L1056P   | 1/0 AWG    | 1/0 - 6 AWG           | 5/16"           | 0.390       | 0.520       | 2.210            | 0.744           | 0.370   | 0.811   | 1.201    | 0.126   | 0.330   | Pink  | 50             |
| L1048    | 1/0 AWG    | 1/0 - 6 AWG           | 1/2"            | 0.390       | 0.520       | 2.500            | 0.744           | 0.472   | 1.063   | 1.201    | 0.126   | 0.512   | Pink  | 50             |
| L2014    | 2/0 AWG    | 2/0 - 4 AWG           | 1/4"            | 0.441       | 0.563       | 2.677            | 0.815           | 0.472   | 1.063   | 1.378    | 0.118   | 0.252   | Black | 25             |
| L2014P   | 2/0 AWG    | 2/0 - 4 AWG           | 1/4"            | 0.441       | 0.563       | 2.677            | 0.815           | 0.472   | 1.063   | 1.378    | 0.118   | 0.252   | Black | 25             |
| L2038    | 2/0 AWG    | 2/0 - 4 AWG           | 3/8"            | 0.441       | 0.563       | 2.677            | 0.815           | 0.472   | 1.063   | 1.378    | 0.118   | 0.413   | Black | 25             |
| L2038P   | 2/0 AWG    | 2/0 - 4 AWG           | 3/8"            | 0.441       | 0.563       | 2.677            | 0.815           | 0.472   | 1.063   | 1.378    | 0.118   | 0.413   | Black | 25             |
| L2048    | 2/0 AWG    | 2/0 - 4 AWG           | 1/2"            | 0.441       | 0.563       | 2.677            | 0.815           | 0.472   | 1.063   | 1.378    | 0.118   | 0.512   | Black | 25             |