

Type UA

UL Listed, CSA Certified
Liquid-Tight Flexible Metal Conduit (LFMC)



Construction

- Constructed of continuously interlocked hot dipped zinc galvanized steel core for exceptional crush and corrosion resistance.
- Durable, sunlight resistant and flame retardant thermoplastic PVC jacket that resists heat, oil and chemical breakdown.
- Convenient markings in feet for easy measurement

Installation

- Conduit used with standard liquid-tight fitting for easy installation. IP 67 Rated when installed with approved fittings.
- Approved for both exposed and concealed locations. Rated for temperature ranges -40°F to + 176°F (-40°C to +80°C).
- Approved as an equipment grounding conductor in sizes 3/8" through 1-1/4" if the total grounding path is 6 ft. or less, and the circuit conductors are protected by overcurrent devices rated at 20 amps or less for 3/8" and 1/2" and 60 amps or less for 3/4" through 1-1/4".
- Suitable for use in hazardous locations per NEC Articles 501 Class I Div. 2, Article 502 Class II Div. 1 & 2, Article 503 Class III Div. 1 & 2.
- Manufactured in a full range of trade sizes from 3/8" through 4".
- Approved for direct burial and in concrete trade sizes 3/8" through 4".
- Complies with UL Standard 360 File No. E18917; CSA C22.2 File No. 158897; and NEC Article 350.

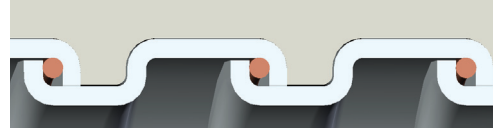

Square-Locked Design with integral bonding wire 3/8" through 1-1/4"



Interlocked Design 1-1/2" through 4" with no bonding wire

NEC Articles

- Article 250.118 (6) Equipment Grounding
- Article 300.22 (D) Information Technology Equipment
- Article 350 Liquid-Tight Flexible Metal Conduit (LFMC)
- Article 501.10 (B) (2) Class I Div. 2
- Article 502.10 (A) (2) and (B) (2) Class II Div. 1 & 2
- Article 503.10 (A) (3) and (B) Class III Div. 1 & 2
- Article 620.21 Elevator Wiring Methods
- Article 645.5 (E) (2) Under Raised Floors

See pages 23-28 for fittings



U.L. LISTED • CSA CERTIFIED • RoHS WEEE COMPLIANT

Type UA

Gray or Black thermoplastic PVC jacket with integral bonding wire 3/8" through 1-1/4"



Product Specifications

Ordering Information

| Electrical Trade Size | | Inside Diameter | | Outside Diameter | | Approx Inside Bend Radius | Approx Weight lbs. | Small Carton | | Standard Carton | | Small Reels | | Standard Reels | |
|-----------------------|-----|-----------------|--------|------------------|--------|---------------------------|--------------------|--------------|--------|-----------------|--------|-------------|--------|----------------|--------|
| Inches | mm | Inches | Inches | Inches | Inches | | | PER | Length | NAED | Length | NAED | Length | NAED | Length |
| | | MIN. | MAX. | MIN. | MAX. | | 100 FT. | Feet | PIN | Feet | PIN | Feet | PIN | Feet | PIN |
| 3/8 | 12 | .484 | -.504 | .690 | -.710 | 3.0 | 25 | 100 | 34202 | 200 | 34201 | 800 | 34204 | 1500 | 34203 |
| 1/2 | 16 | .622 | -.642 | .822 | -.840 | 3.5 | 29 | 100 | 34212 | 200 | 34211 | 500 | 34214 | 1000 | 34213 |
| 3/4 | 21 | .820 | -.840 | 1.030 | 1.050 | 5.0 | 44 | 100 | 34222 | 150 | 34221 | 500 | 34228 | 1000 | 34229 |
| 1 | 27 | 1.041 | 1.066 | 1.290 | 1.315 | 6.0 | 73 | | | 100 | 34231 | 400 | 34238 | | |
| 1-1/4 | 35 | 1.380 | 1.410 | 1.630 | 1.660 | 7.0 | 100 | | | 50 | 34241 | 250 | 34248 | | |
| 1-1/2 | 41 | 1.575 | 1.600 | 1.865 | 1.900 | 5.5 | 112 | | | 50 | 34251 | 150 | 34254 | | |
| 2 | 53 | 2.020 | 2.045 | 2.340 | 2.375 | 7.0 | 148 | | | 50 | 34261 | 100 | 34268 | | |
| 2-1/2 | 63 | 2.480 | 2.505 | 2.840 | 2.875 | 9.5 | 182 | | | 25 | 34272 | | | 100 | 34274 |
| 3 | 78 | 3.070 | 3.100 | 3.460 | 3.500 | 15 | 255 | | | 25 | 34281 | | | 100 | 34284 |
| 3-1/2 | 91 | 3.500 | 3.540 | 3.960 | 4.000 | 16 | 314 | | | 25 | 34301 | | | 100 | 34304 |
| 4 | 103 | 4.000 | 4.040 | 4.460 | 4.500 | 17 | 362 | | | 25 | 34291 | | | 100 | 34294 |

- Note: 1. Gray - Specification above.
 2. Black - Change third number in NAED code to "0".
 3. Other Colors are available upon request.
 4. 3/8" - 3/4" available in 25' and 50' cut lengths
 5. Large reel sizes available upon request.

TYPICAL SPECIFICATION:

Conduit shall be Anaconda SEALTITE® Type UA. Conduit shall provide a flexible liquid-tight raceway for wiring and shall be constructed of continuously interlocked hot dipped zinc galvanized steel core with an integral bonding wire in sizes 3/8" thru 1-1/4". Conduit shall have a sunlight resistant and flame retardant PVC jacket in electrical trade sizes 3/8" thru 4". Conduit shall be UL listed, CSA certified and IP 66/67 rated when installed with approved end fittings.

Type UA

UL Listed, CSA Certified
Liquid-Tight Flexible Metal Conduit (LFMC)



Construction

- Constructed of continuously interlocked hot dipped zinc galvanized steel core for exceptional crush and corrosion resistance.
- Durable, sunlight resistant and flame retardant thermoplastic PVC jacket that resists heat, oil and chemical breakdown.
- Convenient markings in feet for easy measurement

Installation

- Conduit used with standard liquid-tight fitting for easy installation. IP 67 Rated when installed with approved fittings.
- Approved for both exposed and concealed locations. Rated for temperature ranges -40°F to + 176°F (-40°C to +80°C).
- Approved as an equipment grounding conductor in sizes 3/8" through 1-1/4" if the total grounding path is 6 ft. or less, and the circuit conductors are protected by overcurrent devices rated at 20 amps or less for 3/8" and 1/2" and 60 amps or less for 3/4" through 1-1/4".
- Suitable for use in hazardous locations per NEC Articles 501 Class I Div. 2, Article 502 Class II Div. 1 & 2, Article 503 Class III Div. 1 & 2.
- Manufactured in a full range of trade sizes from 3/8" through 4".
- Approved for direct burial and in concrete trade sizes 3/8" through 4".
- Complies with UL Standard 360 File No. E18917; CSA C22.2 File No. 158897; and NEC Article 350.

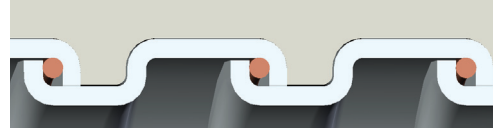

Square-Locked Design with integral bonding wire 3/8" through 1-1/4"



Interlocked Design 1-1/2" through 4" with no bonding wire

NEC Articles

- Article 250.118 (6) Equipment Grounding
- Article 300.22 (D) Information Technology Equipment
- Article 350 Liquid-Tight Flexible Metal Conduit (LFMC)
- Article 501.10 (B) (2) Class I Div. 2
- Article 502.10 (A) (2) and (B) (2) Class II Div. 1 & 2
- Article 503.10 (A) (3) and (B) Class III Div. 1 & 2
- Article 620.21 Elevator Wiring Methods
- Article 645.5 (E) (2) Under Raised Floors

See pages 23-28 for fittings



U.L. LISTED • CSA CERTIFIED • RoHS WEEE COMPLIANT

Type UA

Gray or Black thermoplastic PVC jacket with integral bonding wire 3/8" through 1-1/4"



Product Specifications

Ordering Information

| Electrical Trade Size | | Inside Diameter | | Outside Diameter | | Approx Inside Bend Radius | Approx Weight lbs. | Small Carton | | Standard Carton | | Small Reels | | Standard Reels | |
|-----------------------|-----|-----------------|-------|------------------|-------|---------------------------|--------------------|--------------|--------|-----------------|--------|-------------|--------|----------------|--------|
| Inches | mm | Inches | | Inches | | | | PER | Length | NAED | Length | NAED | Length | NAED | Length |
| | | MIN. | MAX. | MIN. | MAX. | Inches | 100 FT. | Feet | PIN | Feet | PIN | Feet | PIN | Feet | PIN |
| 3/8 | 12 | .484 | -.504 | .690 | -.710 | 3.0 | 25 | 100 | 34202 | 200 | 34201 | 800 | 34204 | 1500 | 34203 |
| 1/2 | 16 | .622 | -.642 | .822 | -.840 | 3.5 | 29 | 100 | 34212 | 200 | 34211 | 500 | 34214 | 1000 | 34213 |
| 3/4 | 21 | .820 | -.840 | 1.030 | 1.050 | 5.0 | 44 | 100 | 34222 | 150 | 34221 | 500 | 34228 | 1000 | 34229 |
| 1 | 27 | 1.041 | 1.066 | 1.290 | 1.315 | 6.0 | 73 | | | 100 | 34231 | 400 | 34238 | | |
| 1-1/4 | 35 | 1.380 | 1.410 | 1.630 | 1.660 | 7.0 | 100 | | | 50 | 34241 | 250 | 34248 | | |
| 1-1/2 | 41 | 1.575 | 1.600 | 1.865 | 1.900 | 5.5 | 112 | | | 50 | 34251 | 150 | 34254 | | |
| 2 | 53 | 2.020 | 2.045 | 2.340 | 2.375 | 7.0 | 148 | | | 50 | 34261 | 100 | 34268 | | |
| 2-1/2 | 63 | 2.480 | 2.505 | 2.840 | 2.875 | 9.5 | 182 | | | 25 | 34272 | | | 100 | 34274 |
| 3 | 78 | 3.070 | 3.100 | 3.460 | 3.500 | 15 | 255 | | | 25 | 34281 | | | 100 | 34284 |
| 3-1/2 | 91 | 3.500 | 3.540 | 3.960 | 4.000 | 16 | 314 | | | 25 | 34301 | | | 100 | 34304 |
| 4 | 103 | 4.000 | 4.040 | 4.460 | 4.500 | 17 | 362 | | | 25 | 34291 | | | 100 | 34294 |

- Note: 1. Gray - Specification above.
 2. Black - Change third number in NAED code to "0".
 3. Other Colors are available upon request.
 4. 3/8" - 3/4" available in 25' and 50' cut lengths
 5. Large reel sizes available upon request.

TYPICAL SPECIFICATION:

Conduit shall be Anaconda SEALTITE® Type UA. Conduit shall provide a flexible liquid-tight raceway for wiring and shall be constructed of continuously interlocked hot dipped zinc galvanized steel core with an integral bonding wire in sizes 3/8" thru 1-1/4". Conduit shall have a sunlight resistant and flame retardant PVC jacket in electrical trade sizes 3/8" thru 4". Conduit shall be UL listed, CSA certified and IP 66/67 rated when installed with approved end fittings.