



HALO[®]

LT | LA Series
LED Retrofit

LT4 4" LED Retrofit Downlight



- Up to 601 lumens (5000K)
- Use to replace 60W PAR16 lamp
- 3000K Correlated Color Temperature (CCT)
- 90 CRI
- 7.5W - 8.0W (per CCT), 120V
- Halo matte white finish
- Push-N-Twist universal installation clips pre-installed
- Compatible with most 4" recessed housings
- Includes Edison base adapter
- Dimmable to 10% with select dimmers
- Damp and wet location listed (shower rated)
- Rated for IC, ICAT and may be used in Non-IC housings
- AIR-TITE™ certified per ASTM-E283-04
- Diffusing, regressed lens
- Five-year limited warranty



Refer to ENERGY STAR® Certified Products List. Can be used to comply with California Title 24 High Efficacy requirements. Certified to California Appliance Efficiency Database under JA8.

Energy Data

Lumens	600 Series
Input Voltage	120V
Input Current	0.069 (A)
Input Power	8.0 (W)
Efficiency	Up to 76 (LPW)
THD: ≤ 24%	
PF: ≥ 0.90	
T Ambient -30 - +40°C	
Sound Rating ≤ 23dba	

Ordering Information

Module

LT460 = 4" integrated LED trim

Finish

WH = Matte White flange

Lumens

6 = 600 lumens (nominal)

CRI/CCT

930 = 90 CRI (minimum), 3000K CCT

Packaging

R = Recyclable 4-color unit carton

T20 Compliant

-CA = California

Accessories

HE26LED = Replacement medium base (E26)
screw base adapter (one included with unit)

See page 16 for compatible
housing information.



HE26LED
Edison Base Adapter
for retrofit (included)

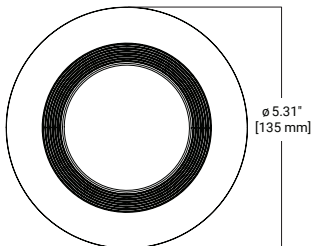
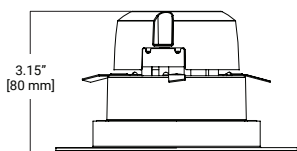

LT4 4" LED SeleCCTable Retrofit Downlight



- Up to 900 lumens
- Use to replace 60W PAR16 lamp
- 5 field selectable CCT option: 2700K, 3000K, 3500K, 4000K, 5000K
- 90 CRI
- 6.6W (600 Lumen) & 9.4W (900 Lumen), 120V
- Halo matte white finish
- Push-N-Twist universal installation clips pre-installed
- Compatible with most 4" recessed housings
- Includes Edison base adapter
- Dimmable to 10% with select dimmers
- Damp and wet location listed (shower rated)
- Rated for IC, ICAT and may be used in Non-IC housings
- AIR-TITE™ certified per ASTM-E283-04
- Diffusing, regressed lens
- Five-year limited warranty



Refer to ENERGY STAR® Certified Products List. Can be used to comply with California Title 24 High Efficacy requirements. Certified to California Appliance Efficiency Database under JA8.

Energy Data

Lumens	650
Input Voltage	120V
Input Current	0.057A
Input Power	6.6W
Efficiency	82.00%
Inrush(A)	1.8
THD	18%
PF	0.95
T Ambient	-30 - +40°C
Sound Rating	18.8db@30cm

Lumens	900
Input Voltage	120V
Input Current	0.08A
Input Power	9.4W
Efficiency	83.00%
Inrush(A)	1.68
THD	16%
PF	0.97
T Ambient	-30 - +40°C
Sound Rating	19.8db@30cm

Ordering Information

Module

LT4 = 4-inch LED retrofit module, baffle trim

Lumens

06 = 600 lumens (nominal)

09 = 900 lumens (nominal)

CRI/CCT

9FS = 90 CRI, field selectable CCT from 2700K, 3000K, 3500K, 4000K, 5000K

Driver

1E = 120V 60Hz, LE & TE phase cut 10% dimming

Finish

WH = Matte White flange

Accessories

HE26LED = Replacement medium base (E26) screw base adapter (one included with unit)

See page 16 for compatible housing information.



HE26LED
Edison Base Adapter
for retrofit (included)

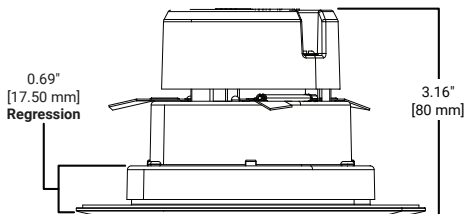

LT4 - Baffle

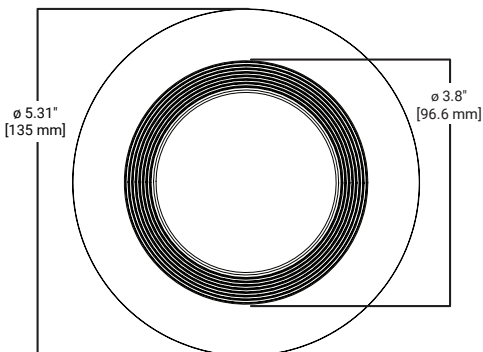

LA4 4" LED All-Purpose Adjustable Gimbal



- Up to 630 lumens (5000K)
- Use to replace 60W PAR16 lamp
- 2700K, 3000K, 3500K, 4000K, 5000K CCT
- 90 CRI
- 8.6W (per CCT), 120V
- Halo matte white finish
- Friction Blade mounting
- Compatible with most 4" recessed housings
- Includes Edison base adapter
- Dimmable to 10% with select dimmers
- Damp and wet location listed (shower rated)
- Rated for IC, ICAT and may be used in Non-IC housings
- AIR-TITE™ certified per ASTM-E283-04
- Diffusing, regressed lens
- Five-year limited warranty



Refer to ENERGY STAR® Certified Products List. Can be used to comply with California Title 24 High Efficacy requirements. Certified to California Appliance Efficiency Database under JA8.

Energy Data	
Lumens	600 Series
Input Voltage	120V
Input Current	0.07 (A)
Input Power	8.6 (W)
Inrush	1.1 (A)
THD: \leq 20%	
PF: \geq 0.90	
T Ambient -30 - +40°C	
Sound Rating \leq 22dba	

Ordering Information

Module

LA4 = 4-Inch LED Adjustable Gimbal

Lumens

06 = 600 lumens (nominal)

CRI/CCT

927=90 CRI, 2700K

930=90 CRI, 3000K

935=90 CRI, 3500K

940=90 CRI, 4000K

950=90 CRI, 5000K

Driver

1E = 120V 60Hz, LE & TE phase cut 10% dimming

Finish

WH = Matte White flange

Accessories

HE26LED = Replacement medium base (E26) screw base adapter (one included with unit)

See page 16 for compatible housing information.



HE26LED
Edison Base Adapter
for retrofit (included)

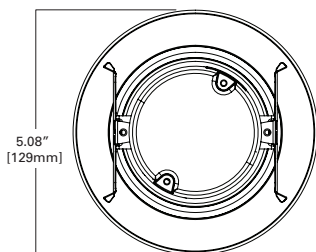
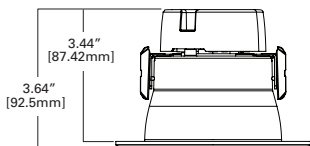

LT56 5"/6" LED Retrofit Downlight



- Up to 772 lumens (5000K)
- Use to replace 65W BR30 or 50W PAR30 lamp
- 3000K Correlated Color Temperature (CCT)
- 90 CRI
- 10.0W - 10.4W (per CCT), 120V
- Halo matte white finish
- Torsion springs pre-installed
- Compatible with most 5" and 6" recessed housings
- Includes Edison base adapter
- Dimmable to 10% with select dimmers
- Damp and wet location listed (shower rated)
- Rated for IC, ICAT and may be used in Non-IC housings
- AIR-TITE™ certified per ASTM-E283-04
- Diffusing, regressed lens
- Five-year limited warranty



Refer to ENERGY STAR® Certified Products List. Can be used to comply with California Title 24 High Efficacy requirements. Certified to California Appliance Efficiency Database under JA8.

Energy Data

Lumens	600 Series
Input Voltage	120V
Input Current	0.089 (A)
Input Power	10.4 (W)
Efficiency	Up to 73 (LPW)
THD: $\leq 24\%$	
PF: ≥ 0.90	
T Ambient -30 - +40°C	
Sound Rating ≤ 23 dba	

Ordering Information

Module

LT560 = 5" and 6" integrated LED trim

Finish

WH = Matte White flange

Lumens

6 = 600 lumens (nominal)

9 = 900 lumens (nominal)

CRI/CCT

930 = 90 CRI (minimum), 3000K CCT

Packaging

R = Recyclable

T20 Compliant

-CA = California

Accessories

HE26LED = Replacement medium base (E26) screw base adapter (one included with unit)

See page 17 for compatible housing information.

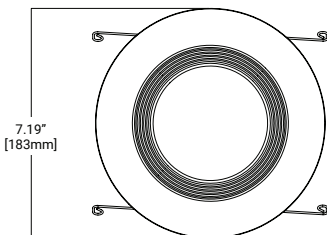
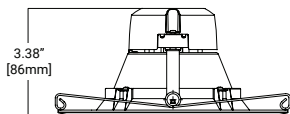

LT56 5" / 6" LED SeleCCTable Retrofit Downlight



- Up to 1200 lumens
- Use to replace 65W BR30 or 50W PAR30 lamp
- 5 field selectable CCT option: 2700K, 3000K, 3500K, 4000K, 5000K
- 90 CRI
- 7.8W (900 Lumen) & 12.4W (1200 Lumen), 120V
- Halo matte white finish
- Torsion springs pre-installed
- Compatible with most 5" and 6" recessed housings
- Includes Edison base adapter
- Dimmable to 10% with select dimmers
- Damp and wet location listed (shower rated)
- Rated for IC, ICAT and may be used in Non-IC housings
- AIR-TITE™ certified per ASTM-E283-04
- Diffusing, regressed lens
- Five-year limited warranty



Refer to ENERGY STAR® Certified Products List. Can be used to comply with California Title 24 High Efficacy requirements. Certified to California Appliance Efficiency Database under JA8.

Energy Data

Lumens	750LM
Input Voltage	120V
Input Current	0.067A
Input Power	7.8W
Efficiency	82.00%
Inrush (A)	2.04
THD	17%
PF	0.96
T Ambient	-30 - +40°C
Sound Rating	19.6db@30cm

Lumens	1200LM
Input Voltage	120V
Input Current	0.105A
Input Power	12.4W
Efficiency	84.00%
Inrush (A)	2.9
THD	14.50%
PF	0.97
T Ambient	-30 - +40°C
Sound Rating	20.2db@30cm

Ordering Information

Module

LT56 = 5-inch/6-inch LED retrofit module, baffle trim

Lumens

07=750 lumen (nominal)

12=1200 lumen (nominal)

CRI/CCT

9FS = 90 CRI, field selectable CCT from 2700K, 3000K, 3500K, 4000K, 5000K

Driver

1E = 120V 60Hz, LE & TE phase cut 10% dimming

Finish

WH = Matte White flange (LT56)

Accessories

HE26LED = Replacement medium base (E26) screw base adapter (one included with unit)

See page 17 for compatible housing information.



HE26LED
Edison Base Adapter
for retrofit (included)

750 Lumens

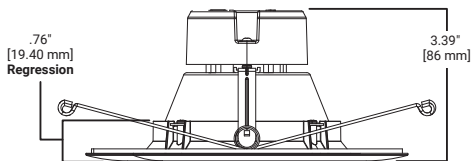

1200 Lumens

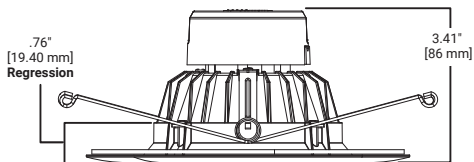

LT56 - Baffle

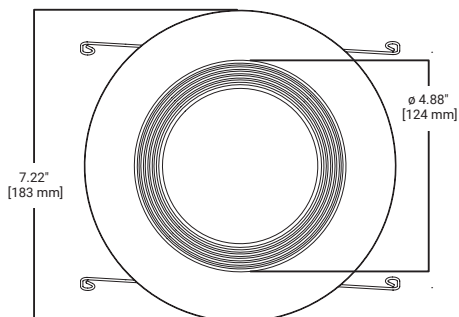

LA56 5"/6" LED All-Purpose Adjustable Gimbal



- Up to 630 lumens (5000K)
- Use to replace 60W PAR16 lamp
- 2700K, 3000K, 3500K, 4000K, 5000K CCT
- 90 CRI
- 8.6W (per CCT), 120V
- Halo matte white finish
- Torsion springs pre-installed
- Compatible with most 5" and 6" recessed housings
- Includes Edison base adapter
- Dimmable to 10% with select dimmers
- Damp and wet location listed (shower rated)
- Rated for IC, ICAT and may be used in Non-IC housings
- AIR-TITE™ certified per ASTM-E283-04
- Diffusing, regressed lens
- Five-year limited warranty



Refer to ENERGY STAR® Certified Products List. Can be used to comply with California Title 24 High Efficacy requirements. Certified to California Appliance Efficiency Database under JA8.

Energy Data

Lumens	600 Series
Input Voltage	120V
Input Current	0.07 (A)
Input Power	8.6 (W)
Inrush	1.1 (A)
THD: ≤ 20%	
PF: ≥ 0.90	
T Ambient -30 - +40°C	
Sound Rating ≤ 22dba	

Ordering Information

Module

LA56 = 5-Inch/6-Inch LED Adjustable Gimbal

Lumens

06 = 600 lumens (nominal)

CRI/CCT

927=90 CRI, 2700K

930=90 CRI, 3000K

935=90 CRI, 3500K

940=90 CRI, 4000K

950=90 CRI, 5000K

Driver

1E = 120V 60Hz, LE & TE phase cut 10% dimming

Finish

WH = Matte White flange

Accessories

HE26LED = Replacement medium base (E26) screw base adapter (one included with unit)

See page 17 for compatible housing information.



HE26LED
Edison Base Adapter
for retrofit (included)

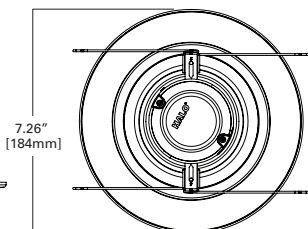
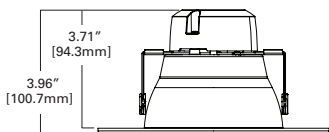

4" Housing Compatibility

LED module is rated for installation in the following 4" HALO®, and other housings.

Halo LED	H995ICAT, H995RICAT, H245ICAT, H245RICAT, H450FR2ICATD010 (Non-screw base, high-efficacy code compliant)
Halo	H99ICAT, H99RTAT, H99TAT, E4ICATSB, E4TATSB, E4RTATSB
Other Brands	The LT and LA Series LED light module - trim combination is cULus Listed or UL Classified for use with any 4" diameter recessed housing constructed of steel or aluminum with an internal volume that exceeds 62.3 in ³ in addition to those noted above.

H995ICAT

4" LED, IC, AIR-TITE,
New Construction Housing

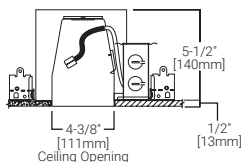

H995RICAT

4" LED, IC, AIR-TITE,
Remodel Housing

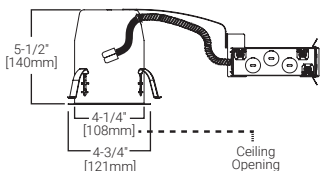

H245ICAT

4" LED, IC, AIR-TITE, Ultra Shallow New Construction Housing

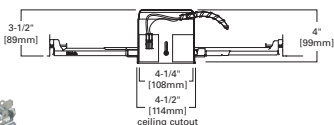

H245RICAT

4" LED, IC, AIR-TITE, Ultra Shallow Remodel Housing

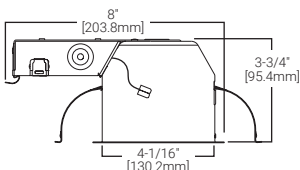

5"/6" Housing Compatibility

LED module is rated for installation in the following 5" and 6" HALO®, and other housings.

Halo 5" LED	H550ICAT, H550RICAT, H550FR2ICATD010 (Non-screw base, high-efficacy code compliant)
Halo 6" LED	H2750ICAT, H750ICAT, H750T, H750TCP, H750FR2ICATD010, H750RICAT, H750RINTD010, H2750RICAT (Non-screw base, high-efficacy code compliant)
Halo 5"	H5T, H5TNB, H5RT, H5TM, H5ICAT, H5ICATNB, H5RICAT, H25ICAT, H25ICATNB E5ICAT, E5ICATNB, E5RICAT, E5TAT, E5TATNB, E5RTAT
Halo 6"	H7ICT, H7ICAT, H7T, H7ICATNB, H7ICTNB, H7TNB, H7UICAT, H7UICT, H7TCP, H7RICAT, H7RICT, H7RT, H27T, H27RT, H27ICAT, H27ICT, H27RICAT, H27RICT E27ICAT, E27RICAT, E27TAT, E27RTAT, E7ICAT, E7ICATNB, E7RICAT, E7TAT, E7TATNB, E7RTAT
Halo LED Retrofit	ML7BXRFK, ML7E26RFK
Other Brands*	The LT and LA Series LED light module - trim combination is cULus Listed or UL Classified for use with any 5"/6" diameter recessed housing constructed of steel or aluminum with an internal volume that exceeds 107.9 in ³ in addition to those noted above.

*When using LT56 and LA56 for retrofit some housings will not have torsion spring receiver brackets –use Halo ML7RAB retrofit adapter band (order separately).

H750ICAT

6" LED, IC, AIR-TITE, Standard New Construction Housing

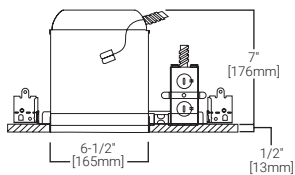

H2750ICAT

6" LED, IC, AIR-TITE, Shallow New Construction Housing

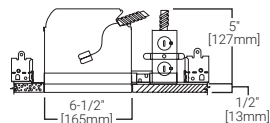

H750RICAT

6" LED, IC, AIR-TITE, Standard Remodel Housing

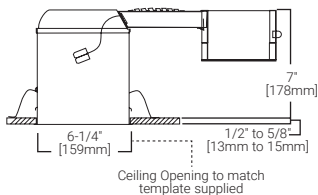

Cooper Lighting Solutions

1121 Highway 74 South
Peachtree City, GA 30269
P: 770-486-4800
www.cooperlighting.com

Canada Sales
5925 McLaughlin Road
Mississauga, Ontario L5R 1B8
P: 905-501-3000
F: 905-501-3172

Lighting Brands

Ametrix
AtLite
Corelite
Ephesus
Fail-Safe
HALO
HALO Commercial
Invue
iO
Iris
Lumark
Lumière
McGraw-Edison
Metalux
MWS
Neo-Ray
Portfolio
PrentaLux - 3D Printed
Lighting
RSA
Shaper
Streetworks
Sure-Lites
Telensa

Controls Brands

Greengate
Fifth Light
Intelligent Lighting Controls

Connected Lighting Systems and Smart Spaces Platform

WaveLinx



© 2023 Cooper Lighting Solutions
All Rights Reserved
Printed in USA
Publication No. BR51839723
July 2023

Products, specifications and
compliances are subject to
change without notice.

Cooper Lighting Solutions is a reg-
istered trademark.
All other trademarks are property
of their respective owners.

