

# Cast Device Box Covers

## FS/FD SINGLE GANG COVER CONFIGURATIONS

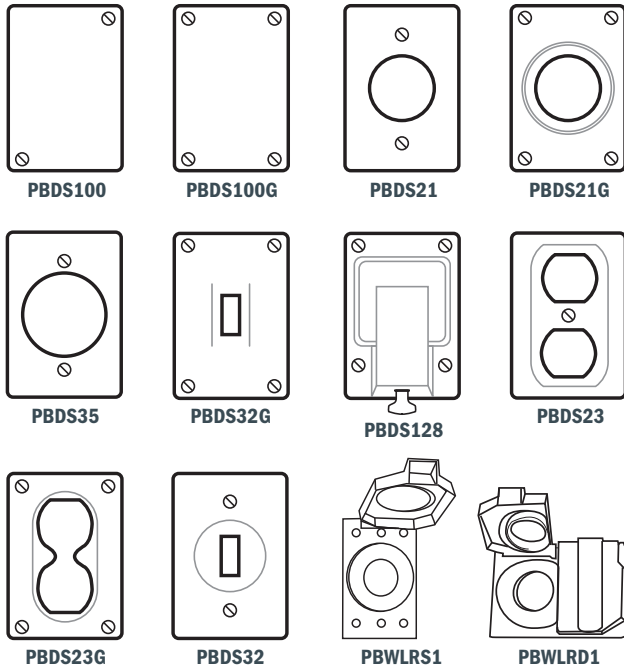

## FS/FD 2 GANG COVER CONFIGURATIONS

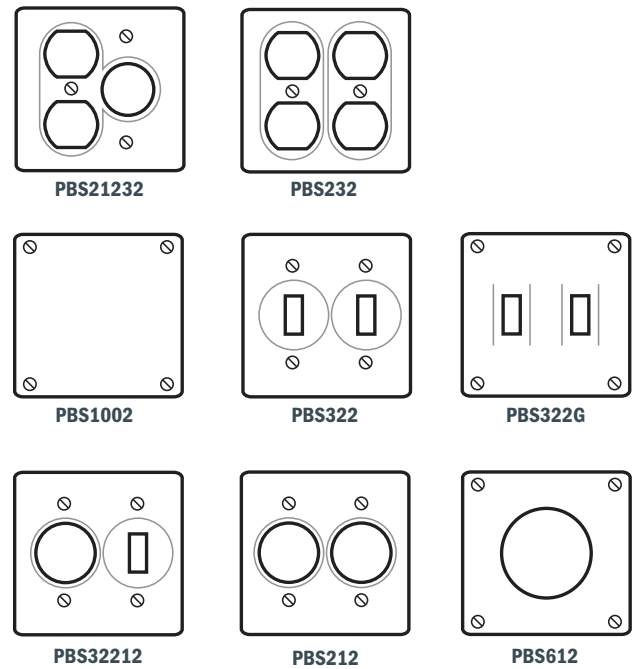

## FERROUS COVERS - ONE GANG

CATALOG #	DESCRIPTION	NOMINAL WEIGHT
PBDS32	GENERAL USE SNAP ON OR TOGGLE (S)	0.4
PBDS23G	DUPLEX CONVENIENCE RECEPTACLE (S,F)	0.4
PBDS35	PLUG RECEPTACLE 1 5/8" DIAMETER (S)	0.4
PBDS21	3P 2W GROUNDING ROUND FLUSH RECEPTACLES (S)	0.3
PBDS21G	3P 2W GROUNDING ROUND FLUSH RECEPTACLES (S,F)	0.3
PBDS23	DUPLEX CONVENIENCE RECEPTACLE (S)	0.3
PBDS32G	SQUARE HANDLE SNAP OR TOGGLE (S, F)	0.4

## FERROUS COVERS - TWO GANG

CATALOG #	DESCRIPTION	NOMINAL WEIGHT
PBS1002	BLANK COVER SHEET STEEL (S)	1.0
PBS1002G	BLANK COVER IRON ALLOY (S,F)	1.0
PBS21232	ROUND RECEPTACLE + DUPLEX CONVENIENCE	1.2
PBS232	DUPLEX CONVENIENCE (S)	1.2
PBS322	SNAP SWITCH (S)	1.0
PBS32212	ROUND RECEPTACLE + SNAP SWITCH (S)	1.2
PBS212	TWO ROUND RECEPTACLES (S)	2.0
PBS612	20 AMP, 250 VOLT RECEPTACLE (S)	1.2
PBS322G	SNAP SWITCHES IRON ALLOY (S,F)	1.2

## ALUMINUM COVERS - ONE GANG

CATALOG #	DESCRIPTION	NOMINAL WEIGHT
PBDS23SA	DUPLEX CONVENIENCE RECEPTACLE (S)	0.1
PBDS100	BLANK COVER (S)	0.1
PBDS128	SNAP SWITCH	0.5
PBDS100G	BLANK COVER CAST (S,F)	0.3
PBWLRD1	SPRING DOOR DUPLEX COVER 1 3/8" (F)	0.4
PBWLR1	SPRING DOOR SINGLE COVER 1 3/8" (F)	0.3
PBWLR2	SPRING DOOR SINGLE COVER 1 1/2" (F)	0.3
PRWLG-FS	SPRING DOOR COVER FOR GFCI (S) - HORIZONTAL	0.5
PRWLG-FSV	SPRING DOOR COVER FOR GFCI (S) - VERTICAL	0.5
PRWLG-F	SPRING DOOR COVER FOR GFCI (F) - HORIZONTAL	0.5

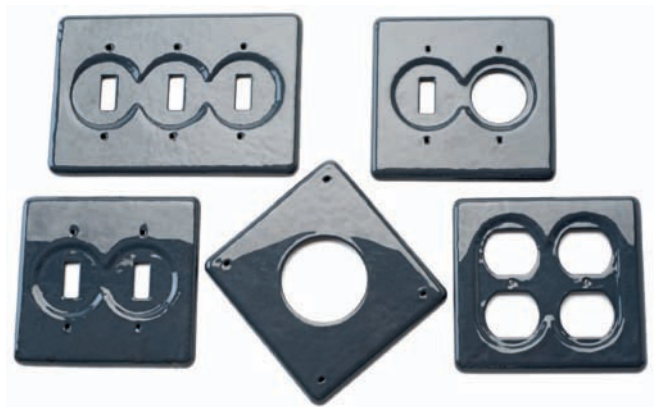

# Cast Device Box Covers

## FS/FD SINGLE GANG COVER CONFIGURATIONS

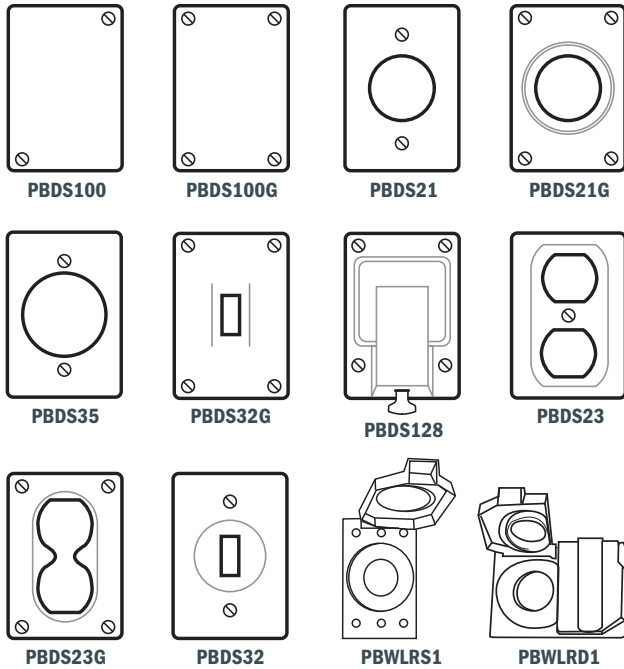

## FS/FD 2 GANG COVER CONFIGURATIONS

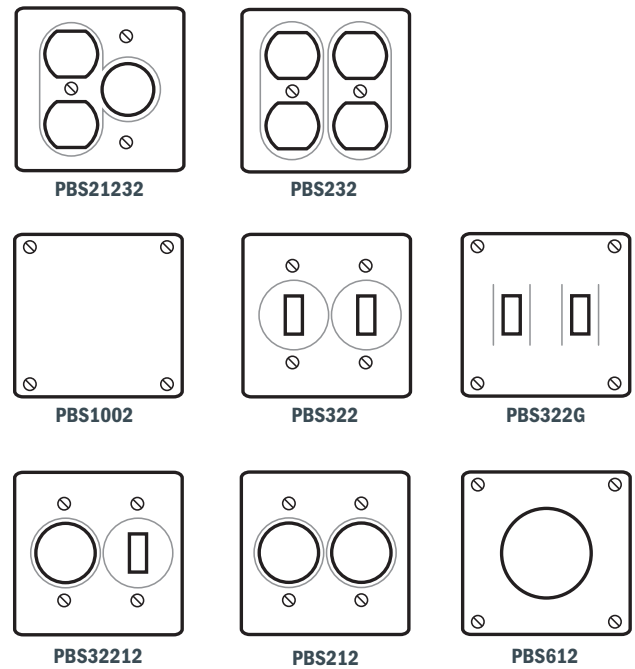

## FERROUS COVERS - ONE GANG

CATALOG #	DESCRIPTION	NOMINAL WEIGHT
PBDS32	GENERAL USE SNAP ON OR TOGGLE (S)	0.4
PBDS23G	DUPLEX CONVENIENCE RECEPTACLE (S,F)	0.4
PBDS35	PLUG RECEPTACLE 1 5/8" DIAMETER (S)	0.4
PBDS21	3P 2W GROUNDING ROUND FLUSH RECEPTACLES (S)	0.3
PBDS21G	3P 2W GROUNDING ROUND FLUSH RECEPTACLES (S,F)	0.3
PBDS23	DUPLEX CONVENIENCE RECEPTACLE (S)	0.3
PBDS32G	SQUARE HANDLE SNAP OR TOGGLE (S, F)	0.4

## FERROUS COVERS - TWO GANG

CATALOG #	DESCRIPTION	NOMINAL WEIGHT
PBS1002	BLANK COVER SHEET STEEL (S)	1.0
PBS1002G	BLANK COVER IRON ALLOY (S,F)	1.0
PBS21232	ROUND RECEPTACLE + DUPLEX CONVENIENCE	1.2
PBS232	DUPLEX CONVENIENCE (S)	1.2
PBS322	SNAP SWITCH (S)	1.0
PBS32212	ROUND RECEPTACLE + SNAP SWITCH (S)	1.2
PBS212	TWO ROUND RECEPTACLES (S)	2.0
PBS612	20 AMP, 250 VOLT RECEPTACLE (S)	1.2
PBS322G	SNAP SWITCHES IRON ALLOY (S,F)	1.2

## ALUMINUM COVERS - ONE GANG

CATALOG #	DESCRIPTION	NOMINAL WEIGHT
PBDS23SA	DUPLEX CONVENIENCE RECEPTACLE (S)	0.1
PBDS100	BLANK COVER (S)	0.1
PBDS128	SNAP SWITCH	0.5
PBDS100G	BLANK COVER CAST (S,F)	0.3
PBWLRD1	SPRING DOOR DUPLEX COVER 1 3/8" (F)	0.4
PBWLR1	SPRING DOOR SINGLE COVER 1 3/8" (F)	0.3
PBWLR2	SPRING DOOR SINGLE COVER 1 1/2" (F)	0.3
PRWLG-FS	SPRING DOOR COVER FOR GFCI (S) - HORIZONTAL	0.5
PRWLG-FSV	SPRING DOOR COVER FOR GFCI (S) - VERTICAL	0.5
PRWLG-F	SPRING DOOR COVER FOR GFCI (F) - HORIZONTAL	0.5

