

GUA Series Conduit Outlet Boxes for Hazardous Locations

Description:

Plasti-Bond REDH₂OT GUA series conduit outlet boxes are installed in hazardous location conduit systems to serve as pull and splice boxes, to change the direction of a conduit run, to connect runs of conduit, or to provide access to conductors. They are provided with covers as standard. Inquire about special covers to allow use to mount lighting fixtures or as sealing fittings. Electrical continuity of the conduit system is maintained across assembled joints.

Features:

- 40 mil gray PVC exterior coating
- 2 mil red urethane interior coating
- Trade sizes from 1/2" through 2" in various styles and configurations
- Sealing sleeves on all conduit openings
- Neoprene O-ring is standard
- Molded-in PVC seal preserves venting characteristics of fitting but seals out corrosives
- Standard material is a cast iron alloy body with a copper-free aluminum cover. Consult Factory for availability of cast iron covers
- Internal green grounding screw is standard



Standards:

Steel and Aluminum

- UL 1203 (E495357)
- CSA C22.2 No. 30
- UL 514A, 514D (E231035)
- CSA C22.2 No. 18, CSA C22.2 No. 42
- NEC/CEC:
 - Class I, Division 1 & 2, Groups C, D
 - Class II, Division 1, Groups E, F, G
 - Class II, Division 2, Groups F, G
 - Class III
- ANSI Standard C-33.27
- NEMA/EEMAC 3,4

GUA SERIES DIMENSIONS

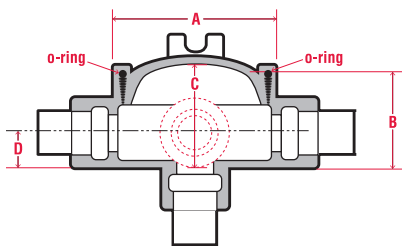

Variables referenced to the technical data charts

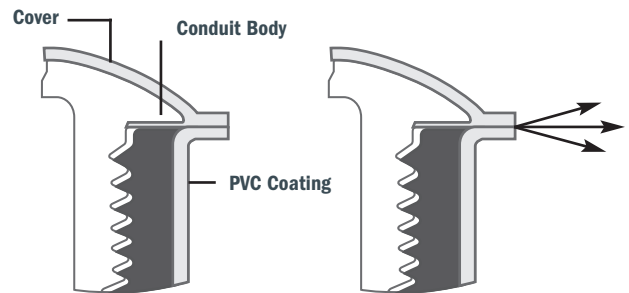

An integral PVC gasket on GUA type fittings preserves the venting characteristics of the uncoated fitting but prevents corrosive liquids from entering from the outside.

GUA SERIES CONFIGURATIONS

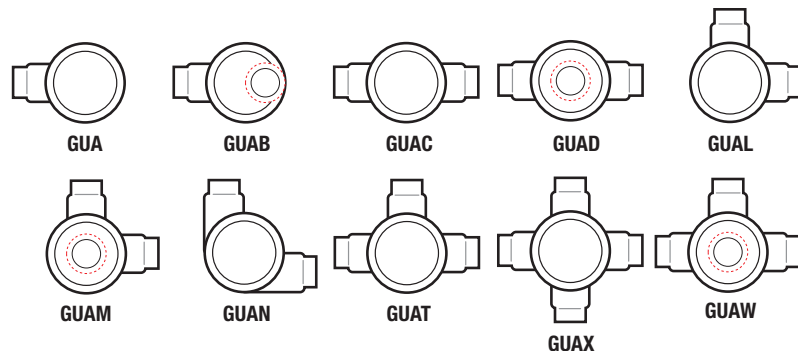

GUA Series Outlet Boxes

GUA Series – Technical Data

GUA

| PIPE SIZE | FERROUS CATALOG # | COVER OPENING | ALUMINUM CATALOG # | PRODUCT DIMENSIONS | | | |
|-----------|-------------------|---------------|--------------------|--------------------|------|------|------|
| | | | | A | B | C | D |
| 1/2" | PRGUA14 | 2" | - | 2.58 | 1.85 | 1.75 | 0.67 |
| 3/4" | PRGUA24 | 2" | - | 2.58 | 2.04 | 2.00 | 0.79 |
| 1/2" | PRGUA16 | 3" | - | 3.58 | 2.04 | 1.88 | 0.67 |
| 3/4" | PRGUA26 | 3" | PRGUA26SA | 3.58 | 2.04 | 1.88 | 0.79 |
| 1" | PRGUA36 | 3" | - | 3.58 | 2.35 | 2.19 | 0.92 |
| 1-1/4" | PRGUA47 | 3-5/8" | - | 4.33 | 2.73 | 2.75 | 1.13 |
| 1-1/2" | PRGUA59 | 5" | - | 5.83 | 3.85 | 3.75 | 1.32 |

GUAC

| PIPE SIZE | FERROUS CATALOG # | COVER OPENING | NOMINAL WEIGHT | ALUMINUM CATALOG # | PRODUCT DIMENSIONS | | | |
|-----------|-------------------|---------------|----------------|--------------------|--------------------|------|------|------|
| | | | | | A | B | C | D |
| 1/2" | PRGUAC14 | 2" | 3.5 | PRGUAC14SA | 2.58 | 2.29 | 2.19 | 0.67 |
| 1/2" | PRGUAC16 | 3" | 2.0 | PRGUAC16SA | 3.58 | 2.04 | 1.88 | 0.67 |
| 3/4" | PRGUAC24 | 2" | 3.5 | PRGUAC24SA | 2.58 | 2.04 | 2.00 | 0.79 |
| 3/4" | PRGUAC26 | 3" | 2.0 | PRGUAC26SA | 3.58 | 2.04 | 1.88 | 0.79 |
| 1" | PRGUAC36 | 3" | 3.9 | PRGUAC36SA | 3.58 | 2.35 | 2.19 | 0.92 |
| 1-1/4" | PRGUAC47 | 3-5/8" | 5.2 | PRGUAC47SA | 4.33 | 2.73 | 2.75 | 1.13 |
| 1-1/4" | PRGUAC49 | 5" | 9.5 | - | 5.83 | 3.85 | 3.75 | 1.20 |
| 1-1/2" | PRGUAC59 | 5" | 11.0 | PRGUAC59SA | 5.83 | 3.85 | 3.75 | 1.32 |
| 2" | PRGUAC69 | 5" | 11.0 | PRGUAC69SA | 5.83 | 4.10 | 4.00 | 1.60 |

GUAL

| PIPE SIZE | FERROUS CATALOG # | COVER OPENING | NOMINAL WEIGHT | ALUMINUM CATALOG # | PRODUCT DIMENSIONS | | | |
|-----------|-------------------|---------------|----------------|--------------------|--------------------|------|------|------|
| | | | | | A | B | C | D |
| 1/2" | PRGUAL14 | 2" | 2.0 | PRGUAL14SA | 2.58 | 1.85 | 1.75 | 0.67 |
| 1/2" | PRGUAL16 | 3" | 2.1 | PRGUAL16SA | 3.58 | 2.04 | 1.88 | 0.67 |
| 3/4" | PRGUAL24 | 2" | 3.2 | PRGUAL24SA | 2.58 | 2.04 | 2.00 | 0.79 |
| 3/4" | PRGUAL26 | 3" | 2.5 | PRGUAL26SA | 3.58 | 2.04 | 1.88 | 0.79 |
| 1" | PRGUAL36 | 3" | 3.7 | PRGUAL36SA | 3.58 | 2.35 | 2.19 | 0.92 |
| 1-1/4" | PRGUAL47 | 3-5/8" | 5.2 | PRGUAL47SA | 4.33 | 2.73 | 2.75 | 1.13 |
| 1-1/4" | PRGUAL49 | 5" | 8.5 | PRGUAL49SA | 5.83 | 3.85 | 3.75 | 1.20 |
| 1-1/2" | PRGUAL59 | 5" | 11.2 | PRGUAL59SA | 5.83 | 3.85 | 3.75 | 1.32 |
| 2" | PRGUAL69 | 5" | 12.5 | PRGUAL69SA | 5.83 | 4.10 | 4.00 | 1.60 |

GUAN

| PIPE SIZE | CATALOG # | COVER OPENING | NOMINAL WEIGHT | PRODUCT DIMENSIONS | | | |
|-----------|-----------|---------------|----------------|--------------------|------|------|------|
| | | | | A | B | C | D |
| 1/2" | PRGUAN14 | 2" | 2.0 | 2.58 | 2.17 | 2.06 | 0.67 |
| 1/2" | PRGUAN16 | 3" | 3.8 | 3.58 | 2.04 | 1.88 | 0.67 |
| 3/4" | PRGUAN24 | 2" | 2.5 | 2.58 | 2.35 | 2.25 | 0.79 |
| 3/4" | PRGUAN26 | 3" | 3.5 | 3.58 | 2.04 | 1.88 | 0.79 |
| 1" | PRGUAN36 | 3" | 3.0 | 3.58 | 2.35 | 2.38 | 0.92 |
| 1-1/4" | PRGUAN47 | 3-5/8" | 5.2 | 4.33 | 2.73 | 2.75 | 1.13 |
| 1-1/2" | PRGUAN59 | 5" | 9.5 | 5.83 | 4.10 | 4.00 | 1.32 |
| 2" | PRGUAN69 | 5" | 12.0 | 5.83 | 4.10 | 4.00 | 1.60 |

GUAW

| PIPE SIZE | CATALOG # | COVER OPENING | NOMINAL WEIGHT | ALUMINUM CATALOG # | PRODUCT DIMENSIONS | | | |
|-----------|-----------|---------------|----------------|--------------------|--------------------|------|------|------|
| | | | | | A | B | C | D |
| 1/2" | PRGUAW14 | 2" | 2.0 | - | 2.58 | 1.85 | 1.75 | 0.67 |
| 1/2" | PRGUAW16 | 3" | 2.0 | - | 3.58 | 2.04 | 1.88 | 0.67 |
| 3/4" | PRGUAW24 | 2" | 3.0 | - | 2.58 | 2.04 | 2.00 | 0.79 |
| 3/4" | PRGUAW26 | 3" | 3.0 | PRGUAW26SA | 3.58 | 2.04 | 1.88 | 0.79 |

GUAB

| PIPE SIZE | FERROUS CATALOG # | COVER OPENING | NOMINAL WEIGHT | ALUMINUM CATALOG # | PRODUCT DIMENSIONS | | | |
|-----------|-------------------|---------------|----------------|--------------------|--------------------|------|------|------|
| | | | | | A | B | C | D |
| 1/2" | PRGUAB14 | 2" | 2.0 | PRGUAB14SA | 2.58 | 2.29 | 2.19 | 0.67 |
| 1/2" | PRGUAB16 | 3" | 3.2 | PRGUAB16SA | 3.58 | 2.04 | 1.88 | 0.67 |
| 3/4" | PRGUAB24 | 2" | 2.2 | - | 2.58 | 2.54 | 2.44 | 0.79 |
| 3/4" | PRGUAB26 | 3" | 3.3 | PRGUAB26SA | 3.58 | 2.04 | 1.88 | 0.79 |
| 1" | PRGUAB36 | 3" | 3.8 | PRGUAB36SA | 3.58 | 2.35 | 2.19 | 0.92 |
| 1-1/4" | PRGUAB47 | 3-5/8" | 5.0 | PRGUAB47SA | 4.33 | 2.73 | 2.75 | 1.13 |
| 1-1/2" | PRGUAB59 | 5" | 8.1 | PRGUAB59SA | 5.83 | 3.85 | 3.75 | 1.32 |
| 2" | PRGUAB69 | 5" | 9.1 | PRGUAB69SA | 5.83 | 4.10 | 4.00 | 1.60 |

GUAD

| PIPE SIZE | CATALOG # | COVER OPENING | NOMINAL WEIGHT | ALUMINUM CATALOG # | PRODUCT DIMENSIONS | | | |
|-----------|-----------|---------------|----------------|--------------------|--------------------|------|------|------|
| | | | | | A | B | C | D |
| 1/2" | PRGUAD14 | 2" | 2.0 | - | 2.58 | 1.85 | 1.75 | 0.67 |
| 1/2" | PRGUAD16 | 3" | 3.2 | - | 3.58 | 2.04 | 1.88 | 0.67 |
| 3/4" | PRGUAD24 | 2" | 3.5 | - | 2.58 | 2.04 | 2.00 | 0.79 |
| 3/4" | PRGUAD26 | 3" | 3.8 | PRGUAD26SA | 3.58 | 2.04 | 1.88 | 0.79 |
| 1" | PRGUAD36 | 3" | 3.8 | PRGUAD36SA | 3.58 | 2.35 | 2.19 | 0.92 |
| 1-1/4" | PRGUAD49 | 5" | 10.9 | - | 5.83 | 3.85 | 3.75 | 1.13 |

GUAM

| PIPE SIZE | FERROUS CATALOG # | COVER OPENING | NOMINAL WEIGHT | ALUMINUM CATALOG # | PRODUCT DIMENSIONS | | | |
|-----------|-------------------|---------------|----------------|--------------------|--------------------|------|------|------|
| | | | | | A | B | C | D |
| 1/2" | PRGUAM14 | 2" | 2.0 | PRGUAM14SA | 2.58 | 1.85 | 1.75 | 0.67 |
| 3/4" | PRGUAM24 | 2" | 2.2 | - | 2.58 | 2.04 | 2.00 | 0.79 |
| 1/2" | PRGUAM16 | 3" | 3.2 | - | 3.58 | 2.04 | 1.88 | 0.67 |
| 3/4" | PRGUAM26 | 3" | 3.3 | - | 3.58 | 2.04 | 1.88 | 0.79 |
| 1" | PRGUAM36 | 3" | 3.8 | - | 3.58 | 2.35 | 2.19 | 0.92 |
| 1-1/4" | PRGUAM47 | 3-5/8" | 5.0 | - | 4.33 | 2.73 | 2.75 | 1.13 |
| 2" | PRGUAM69 | 5" | 9.1 | - | 5.83 | 4.10 | 4.00 | 1.60 |

GUAT

| PIPE SIZE | FERROUS CATALOG # | COVER OPENING | NOMINAL WEIGHT | ALUMINUM CATALOG # | PRODUCT DIMENSIONS | | | |
|-----------|-------------------|---------------|----------------|--------------------|--------------------|------|------|------|
| | | | | | A | B | C | D |
| 1/2" | PRGUAT14 | 2" | 2.0 | PRGUAT14SA | 2.58 | 2.29 | 2.19 | 0.67 |
| 1/2" | PRGUAT16 | 3" | 2.8 | PRGUAT16SA | 3.58 | 2.04 | 1.88 | 0.67 |
| 3/4" | PRGUAT24 | 2" | 2.2 | PRGUAT24SA | 2.58 | 2.04 | 2.00 | 0.79 |
| 3/4" | PRGUAT26 | 3" | 3.5 | PRGUAT26SA | 3.58 | 2.04 | 1.88 | 0.79 |
| 1" | PRGUAT36 | 3" | 3.2 | PRGUAT36SA | 3.58 | 2.35 | 2.19 | 0.92 |
| 1-1/4" | PRGUAT47 | 3-5/8" | 5.7 | PRGUAT47SA | 4.33 | 2.73 | 2.75 | 1.13 |
| 1-1/2" | PRGUAT59 | 5" | 9.1 | PRGUAT59SA | 5.83 | 3.85 | 3.75 | 1.32 |
| 2" | PRGUAT69 | 5" | 10.0 | PRGUAT69SA | 5.83 | 4.10 | 4.00 | 1.60 |

GUAX

| PIPE SIZE | FERROUS CATALOG # | COVER OPENING | NOMINAL WEIGHT | ALUMINUM CATALOG # | PRODUCT DIMENSIONS | | | |
|-----------|-------------------|---------------|----------------|--------------------|--------------------|------|------|------|
| | | | | | A | B | C | D |
| 1/2" | PRGUAX14 | 2" | 2.0 | - | 2.58 | 1.85 | 1.75 | 0.67 |
| 1/2" | PRGUAX16 | 3" | 3.8 | PRGUAX16SA | 3.58 | 2.04 | 1.88 | 0.67 |
| 3/4" | PRGUAX24 | 2" | 2.5 | PRGUAX24SA | 2.58 | 2.04 | 2.00 | 0.79 |
| 3/4" | PRGUAX26 | 3" | 2.8 | PRGUAX26SA | 3.58 | 2.04 | 1.88 | 0.79 |
| 1" | PRGUAX36 | 3" | 4.2 | PRGUAX36SA | 3.58 | 2.35 | 2.19 | 0.92 |
| 1-1/4" | PRGUAX47 | 3-5/8" | 4.8 | PRGUAX47SA | 4.33 | 2.73 | 2.75 | 1.13 |
| 1-1/2" | PRGUAX59 | 5" | 11.7 | PRGUAX59SA | 5.83 | 3.85 | 3.75 | 1.32 |
| 2" | PRGUAX69 | 5" | 12.5 | PRGUAX69SA | 5.83 | 4.10 | 4.00 | 1.60 |



Contact us:
customerservice@plastibond.com



Visit www.plastibond.com
For more information

GUA Series Conduit Outlet Boxes for Hazardous Locations

Description:

Plasti-Bond REDH₂OT GUA series conduit outlet boxes are installed in hazardous location conduit systems to serve as pull and splice boxes, to change the direction of a conduit run, to connect runs of conduit, or to provide access to conductors. They are provided with covers as standard. Inquire about special covers to allow use to mount lighting fixtures or as sealing fittings. Electrical continuity of the conduit system is maintained across assembled joints.

Features:

- 40 mil gray PVC exterior coating
- 2 mil red urethane interior coating
- Trade sizes from 1/2" through 2" in various styles and configurations
- Sealing sleeves on all conduit openings
- Neoprene O-ring is standard
- Molded-in PVC seal preserves venting characteristics of fitting but seals out corrosives
- Standard material is a cast iron alloy body with a copper-free aluminum cover. Consult Factory for availability of cast iron covers
- Internal green grounding screw is standard



Standards:

Steel and Aluminum

- UL 1203 (E495357)
- CSA C22.2 No. 30
- UL 514A, 514D (E231035)
- CSA C22.2 No. 18, CSA C22.2 No. 42
- NEC/CEC:
 - Class I, Division 1 & 2, Groups C, D
 - Class II, Division 1, Groups E, F, G
 - Class II, Division 2, Groups F, G
 - Class III
- ANSI Standard C-33.27
- NEMA/EEMAC 3,4

GUA SERIES DIMENSIONS

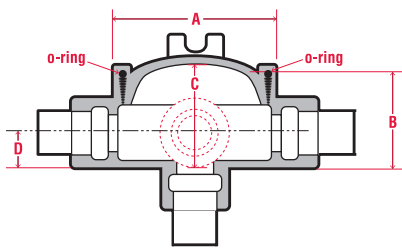

Variables referenced to the technical data charts

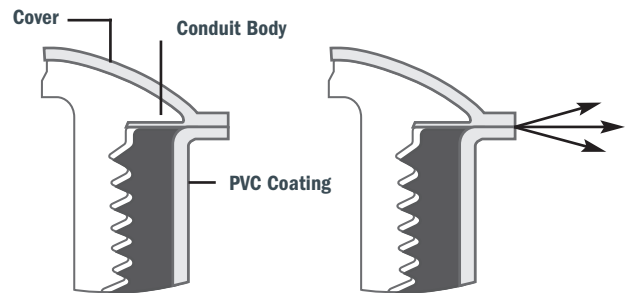

An integral PVC gasket on GUA type fittings preserves the venting characteristics of the uncoated fitting but prevents corrosive liquids from entering from the outside.

GUA SERIES CONFIGURATIONS



GUA Series Outlet Boxes

GUA Series – Technical Data

GUA

| PIPE SIZE | FERROUS CATALOG # | COVER OPENING | ALUMINUM CATALOG # | PRODUCT DIMENSIONS | | | |
|-----------|-------------------|---------------|--------------------|--------------------|------|------|------|
| | | | | A | B | C | D |
| 1/2" | PRGUA14 | 2" | - | 2.58 | 1.85 | 1.75 | 0.67 |
| 3/4" | PRGUA24 | 2" | - | 2.58 | 2.04 | 2.00 | 0.79 |
| 1/2" | PRGUA16 | 3" | - | 3.58 | 2.04 | 1.88 | 0.67 |
| 3/4" | PRGUA26 | 3" | PRGUA26SA | 3.58 | 2.04 | 1.88 | 0.79 |
| 1" | PRGUA36 | 3" | - | 3.58 | 2.35 | 2.19 | 0.92 |
| 1-1/4" | PRGUA47 | 3-5/8" | - | 4.33 | 2.73 | 2.75 | 1.13 |
| 1-1/2" | PRGUA59 | 5" | - | 5.83 | 3.85 | 3.75 | 1.32 |

GUAC

| PIPE SIZE | FERROUS CATALOG # | COVER OPENING | NOMINAL WEIGHT | ALUMINUM CATALOG # | PRODUCT DIMENSIONS | | | |
|-----------|-------------------|---------------|----------------|--------------------|--------------------|------|------|------|
| | | | | | A | B | C | D |
| 1/2" | PRGUAC14 | 2" | 3.5 | PRGUAC14SA | 2.58 | 2.29 | 2.19 | 0.67 |
| 1/2" | PRGUAC16 | 3" | 2.0 | PRGUAC16SA | 3.58 | 2.04 | 1.88 | 0.67 |
| 3/4" | PRGUAC24 | 2" | 3.5 | PRGUAC24SA | 2.58 | 2.04 | 2.00 | 0.79 |
| 3/4" | PRGUAC26 | 3" | 2.0 | PRGUAC26SA | 3.58 | 2.04 | 1.88 | 0.79 |
| 1" | PRGUAC36 | 3" | 3.9 | PRGUAC36SA | 3.58 | 2.35 | 2.19 | 0.92 |
| 1-1/4" | PRGUAC47 | 3-5/8" | 5.2 | PRGUAC47SA | 4.33 | 2.73 | 2.75 | 1.13 |
| 1-1/4" | PRGUAC49 | 5" | 9.5 | - | 5.83 | 3.85 | 3.75 | 1.20 |
| 1-1/2" | PRGUAC59 | 5" | 11.0 | PRGUAC59SA | 5.83 | 3.85 | 3.75 | 1.32 |
| 2" | PRGUAC69 | 5" | 11.0 | PRGUAC69SA | 5.83 | 4.10 | 4.00 | 1.60 |

GUAL

| PIPE SIZE | FERROUS CATALOG # | COVER OPENING | NOMINAL WEIGHT | ALUMINUM CATALOG # | PRODUCT DIMENSIONS | | | |
|-----------|-------------------|---------------|----------------|--------------------|--------------------|------|------|------|
| | | | | | A | B | C | D |
| 1/2" | PRGUAL14 | 2" | 2.0 | PRGUAL14SA | 2.58 | 1.85 | 1.75 | 0.67 |
| 1/2" | PRGUAL16 | 3" | 2.1 | PRGUAL16SA | 3.58 | 2.04 | 1.88 | 0.67 |
| 3/4" | PRGUAL24 | 2" | 3.2 | PRGUAL24SA | 2.58 | 2.04 | 2.00 | 0.79 |
| 3/4" | PRGUAL26 | 3" | 2.5 | PRGUAL26SA | 3.58 | 2.04 | 1.88 | 0.79 |
| 1" | PRGUAL36 | 3" | 3.7 | PRGUAL36SA | 3.58 | 2.35 | 2.19 | 0.92 |
| 1-1/4" | PRGUAL47 | 3-5/8" | 5.2 | PRGUAL47SA | 4.33 | 2.73 | 2.75 | 1.13 |
| 1-1/4" | PRGUAL49 | 5" | 8.5 | PRGUAL49SA | 5.83 | 3.85 | 3.75 | 1.20 |
| 1-1/2" | PRGUAL59 | 5" | 11.2 | PRGUAL59SA | 5.83 | 3.85 | 3.75 | 1.32 |
| 2" | PRGUAL69 | 5" | 12.5 | PRGUAL69SA | 5.83 | 4.10 | 4.00 | 1.60 |

GUAN

| PIPE SIZE | CATALOG # | COVER OPENING | NOMINAL WEIGHT | PRODUCT DIMENSIONS | | | |
|-----------|-----------|---------------|----------------|--------------------|------|------|------|
| | | | | A | B | C | D |
| 1/2" | PRGUAN14 | 2" | 2.0 | 2.58 | 2.17 | 2.06 | 0.67 |
| 1/2" | PRGUAN16 | 3" | 3.8 | 3.58 | 2.04 | 1.88 | 0.67 |
| 3/4" | PRGUAN24 | 2" | 2.5 | 2.58 | 2.35 | 2.25 | 0.79 |
| 3/4" | PRGUAN26 | 3" | 3.5 | 3.58 | 2.04 | 1.88 | 0.79 |
| 1" | PRGUAN36 | 3" | 3.0 | 3.58 | 2.35 | 2.38 | 0.92 |
| 1-1/4" | PRGUAN47 | 3-5/8" | 5.2 | 4.33 | 2.73 | 2.75 | 1.13 |
| 1-1/2" | PRGUAN59 | 5" | 9.5 | 5.83 | 4.10 | 4.00 | 1.32 |
| 2" | PRGUAN69 | 5" | 12.0 | 5.83 | 4.10 | 4.00 | 1.60 |

GUAW

| PIPE SIZE | CATALOG # | COVER OPENING | NOMINAL WEIGHT | ALUMINUM CATALOG # | PRODUCT DIMENSIONS | | | |
|-----------|-----------|---------------|----------------|--------------------|--------------------|------|------|------|
| | | | | | A | B | C | D |
| 1/2" | PRGUAW14 | 2" | 2.0 | - | 2.58 | 1.85 | 1.75 | 0.67 |
| 1/2" | PRGUAW16 | 3" | 2.0 | - | 3.58 | 2.04 | 1.88 | 0.67 |
| 3/4" | PRGUAW24 | 2" | 3.0 | - | 2.58 | 2.04 | 2.00 | 0.79 |
| 3/4" | PRGUAW26 | 3" | 3.0 | PRGUAW26SA | 3.58 | 2.04 | 1.88 | 0.79 |

GUAB

| PIPE SIZE | FERROUS CATALOG # | COVER OPENING | NOMINAL WEIGHT | ALUMINUM CATALOG # | PRODUCT DIMENSIONS | | | |
|-----------|-------------------|---------------|----------------|--------------------|--------------------|------|------|------|
| | | | | | A | B | C | D |
| 1/2" | PRGUAB14 | 2" | 2.0 | PRGUAB14SA | 2.58 | 2.29 | 2.19 | 0.67 |
| 1/2" | PRGUAB16 | 3" | 3.2 | PRGUAB16SA | 3.58 | 2.04 | 1.88 | 0.67 |
| 3/4" | PRGUAB24 | 2" | 2.2 | - | 2.58 | 2.54 | 2.44 | 0.79 |
| 3/4" | PRGUAB26 | 3" | 3.3 | PRGUAB26SA | 3.58 | 2.04 | 1.88 | 0.79 |
| 1" | PRGUAB36 | 3" | 3.8 | PRGUAB36SA | 3.58 | 2.35 | 2.19 | 0.92 |
| 1-1/4" | PRGUAB47 | 3-5/8" | 5.0 | PRGUAB47SA | 4.33 | 2.73 | 2.75 | 1.13 |
| 1-1/2" | PRGUAB59 | 5" | 8.1 | PRGUAB59SA | 5.83 | 3.85 | 3.75 | 1.32 |
| 2" | PRGUAB69 | 5" | 9.1 | PRGUAB69SA | 5.83 | 4.10 | 4.00 | 1.60 |

GUAD

| PIPE SIZE | CATALOG # | COVER OPENING | NOMINAL WEIGHT | ALUMINUM CATALOG # | PRODUCT DIMENSIONS | | | |
|-----------|-----------|---------------|----------------|--------------------|--------------------|------|------|------|
| | | | | | A | B | C | D |
| 1/2" | PRGUAD14 | 2" | 2.0 | - | 2.58 | 1.85 | 1.75 | 0.67 |
| 1/2" | PRGUAD16 | 3" | 3.2 | - | 3.58 | 2.04 | 1.88 | 0.67 |
| 3/4" | PRGUAD24 | 2" | 3.5 | - | 2.58 | 2.04 | 2.00 | 0.79 |
| 3/4" | PRGUAD26 | 3" | 3.8 | PRGUAD26SA | 3.58 | 2.04 | 1.88 | 0.79 |
| 1" | PRGUAD36 | 3" | 3.8 | PRGUAD36SA | 3.58 | 2.35 | 2.19 | 0.92 |
| 1-1/4" | PRGUAD49 | 5" | 10.9 | - | 5.83 | 3.85 | 3.75 | 1.13 |

GUAM

| PIPE SIZE | FERROUS CATALOG # | COVER OPENING | NOMINAL WEIGHT | ALUMINUM CATALOG # | PRODUCT DIMENSIONS | | | |
|-----------|-------------------|---------------|----------------|--------------------|--------------------|------|------|------|
| | | | | | A | B | C | D |
| 1/2" | PRGUAM14 | 2" | 2.0 | PRGUAM14SA | 2.58 | 1.85 | 1.75 | 0.67 |
| 3/4" | PRGUAM24 | 2" | 2.2 | - | 2.58 | 2.04 | 2.00 | 0.79 |
| 1/2" | PRGUAM16 | 3" | 3.2 | - | 3.58 | 2.04 | 1.88 | 0.67 |
| 3/4" | PRGUAM26 | 3" | 3.3 | - | 3.58 | 2.04 | 1.88 | 0.79 |
| 1" | PRGUAM36 | 3" | 3.8 | - | 3.58 | 2.35 | 2.19 | 0.92 |
| 1-1/4" | PRGUAM47 | 3-5/8" | 5.0 | - | 4.33 | 2.73 | 2.75 | 1.13 |
| 2" | PRGUAM69 | 5" | 9.1 | - | 5.83 | 4.10 | 4.00 | 1.60 |

GUAT

| PIPE SIZE | FERROUS CATALOG # | COVER OPENING | NOMINAL WEIGHT | ALUMINUM CATALOG # | PRODUCT DIMENSIONS | | | |
|-----------|-------------------|---------------|----------------|--------------------|--------------------|------|------|------|
| | | | | | A | B | C | D |
| 1/2" | PRGUAT14 | 2" | 2.0 | PRGUAT14SA | 2.58 | 2.29 | 2.19 | 0.67 |
| 1/2" | PRGUAT16 | 3" | 2.8 | PRGUAT16SA | 3.58 | 2.04 | 1.88 | 0.67 |
| 3/4" | PRGUAT24 | 2" | 2.2 | PRGUAT24SA | 2.58 | 2.04 | 2.00 | 0.79 |
| 3/4" | PRGUAT26 | 3" | 3.5 | PRGUAT26SA | 3.58 | 2.04 | 1.88 | 0.79 |
| 1" | PRGUAT36 | 3" | 3.2 | PRGUAT36SA | 3.58 | 2.35 | 2.19 | 0.92 |
| 1-1/4" | PRGUAT47 | 3-5/8" | 5.7 | PRGUAT47SA | 4.33 | 2.73 | 2.75 | 1.13 |
| 1-1/2" | PRGUAT59 | 5" | 9.1 | PRGUAT59SA | 5.83 | 3.85 | 3.75 | 1.32 |
| 2" | PRGUAT69 | 5" | 10.0 | PRGUAT69SA | 5.83 | 4.10 | 4.00 | 1.60 |

GUAX

| PIPE SIZE | FERROUS CATALOG # | COVER OPENING | NOMINAL WEIGHT | ALUMINUM CATALOG # | PRODUCT DIMENSIONS | | | |
|-----------|-------------------|---------------|----------------|--------------------|--------------------|------|------|------|
| | | | | | A | B | C | D |
| 1/2" | PRGUAX14 | 2" | 2.0 | - | 2.58 | 1.85 | 1.75 | 0.67 |
| 1/2" | PRGUAX16 | 3" | 3.8 | PRGUAX16SA | 3.58 | 2.04 | 1.88 | 0.67 |
| 3/4" | PRGUAX24 | 2" | 2.5 | PRGUAX24SA | 2.58 | 2.04 | 2.00 | 0.79 |
| 3/4" | PRGUAX26 | 3" | 2.8 | PRGUAX26SA | 3.58 | 2.04 | 1.88 | 0.79 |
| 1" | PRGUAX36 | 3" | 4.2 | PRGUAX36SA | 3.58 | 2.35 | 2.19 | 0.92 |
| 1-1/4" | PRGUAX47 | 3-5/8" | 4.8 | PRGUAX47SA | 4.33 | 2.73 | 2.75 | 1.13 |
| 1-1/2" | PRGUAX59 | 5" | 11.7 | PRGUAX59SA | 5.83 | 3.85 | 3.75 | 1.32 |
| 2" | PRGUAX69 | 5" | 12.5 | PRGUAX69SA | 5.83 | 4.10 | 4.00 | 1.60 |



Contact us:
customerservice@plastibond.com

Visit www.plastibond.com
For more information