

Industrial LED luminaires
Exit and Emergency

Sure-Lites



EATON

Powering Business Worldwide

SEL/SELM Indoor

WAREHOUSE / DISTRIBUTION | MANUFACTURING | GYMNASIUMS / MULTI-PURPOSE ROOMS / ATHLETIC CENTER | BIG BOX / RETAIL

SEL



Polycarbonate

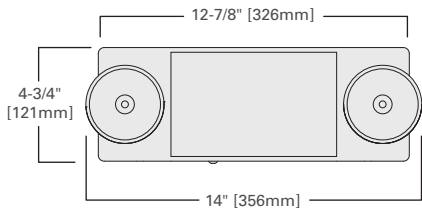

SELM



Metal

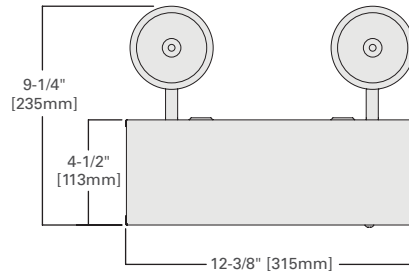

Feature	Benefit
Up to 60 feet of egress coverage	Up to \$300 savings on installation
LED source with Nickel cadmium battery	Up to ten years with no maintenance
Optional remote capacity	Indoor, outdoor design flexibility
Self diagnostics w/laser test	Reduce labor of NFPA/OSHA testing

Certification/warranty
UL924 damp location
NFPA 101 compliant
NEC/OSHA compliant
5-year product warranty
7-year prorated battery warranty

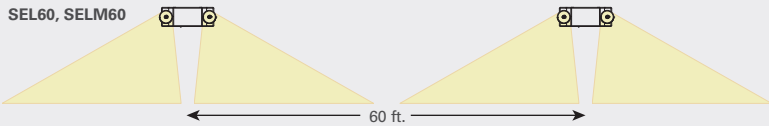

SELW/SELD Outdoor

WAREHOUSE / DISTRIBUTION | MANUFACTURING | GYMNASIUMS / MULTI-PURPOSE ROOMS / ATHLETIC CENTER | BIG BOX / RETAIL

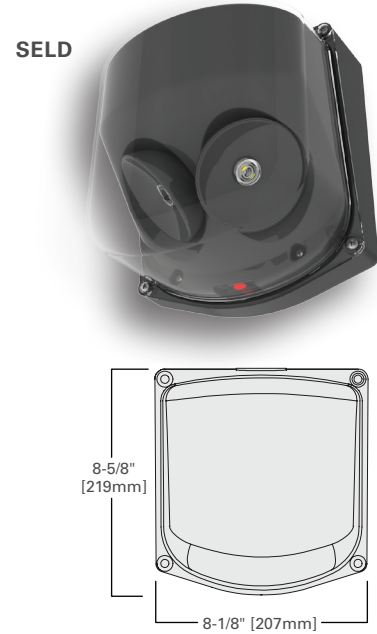
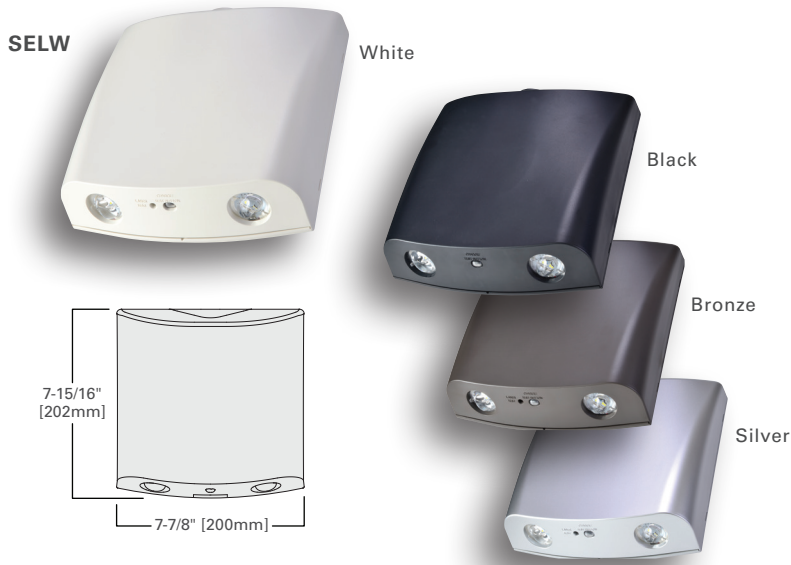

Feature	Benefit
LED source with Nickel cadmium battery	Up to ten years with no maintenance
Forward throw optic	Maximum design flexibility
29 feet spacing	Less fixtures required
Self diagnostics w/laser test	Reduce labor of NFPA/OSHA testing

Feature	Benefit
LED source with Nickel cadmium battery	Up to ten years with no maintenance
58 foot spacing	Less fixtures required
Standard Self diagnostics with laser test	Reduce labor of NFPA/OSHA testing
NEMA 4X; IP66; - 30° C to 50° C	Maximum design flexibility

Certification/warranty
UL924 wet location
NFPA 101 compliant
NEC/OSHA compliant
5-year product warranty
7-year prorated battery warranty

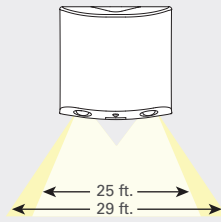

Certification
UL924 wet location
NEMA 4X
NFPA 101 compliant
NEC/OSHA compliant
IP66
NSF
IP66HAZ (class 1, Div 2) option

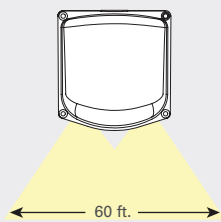

LPX Exit

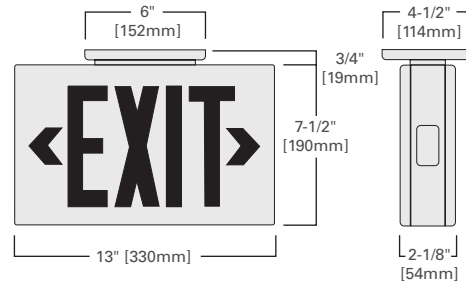

Feature	Benefit
LED source with Nickel cadmium battery	Up to ten years with no maintenance
Field adjustable for red or green	Maximum design flexibility
Optional emergency heads or remote capacity	Less fixtures required
Standard Self diagnostics with laser test	Reduce labor of NFPA/OSHA testing

Certification/warranty
UL924 damp location
NFPA 101 compliant
NEC/OSHA compliant
5-year product warranty
7-year prorated battery warranty



LPX LED Combo

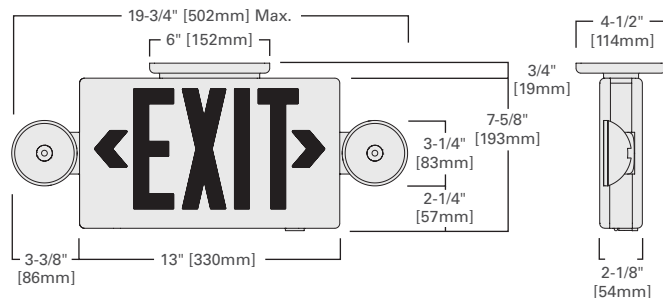

UX Exit

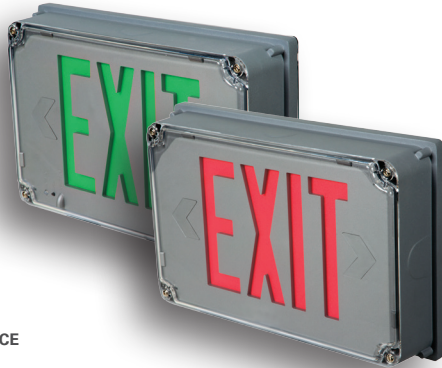

SINGLE FACE

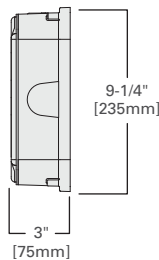
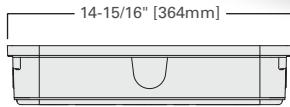

LPWX Exit

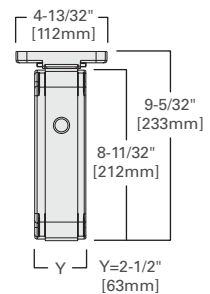
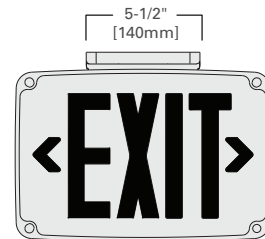
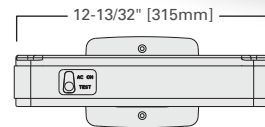

Feature	Benefit
LED source with Nickel cadmium battery	Up to ten years with no maintenance
Field adjustable for red or green	Maximum design flexibility
Standard Self diagnostics with laser test	Reduce labor of NFPA/OSHA testing
NEMA 4X; IP66; - 30° C to 50° C	Maximum design flexibility

Certification/warranty
UL924 wet location
NEMA 4X/IP66
NFPA 101 compliant
NEC/OSHA/NSF compliant
HAZ (class 1, Div 2) rated option
NSF
5-year product warranty, 7-year prorated battery warranty

Feature	Benefit
LED source with Nickel cadmium battery	Up to ten years with no maintenance
UV stabilized polycarbonate housing	Outdoor capable
Standard Self diagnostics with laser test	Reduce labor of NFPA/OSHA testing
Wet location listed; - 30° C to 50° C	Maximum design flexibility

Certification/warranty
UL924 wet location
NFPA 101 compliant
NEC/OSHA compliant
5-year product warranty, 7-year prorated battery warranty



Lighting Product Lines

Halo
Halo Commercial
Portfolio
Iris
RSA
Metalux
Corelite
Neo-Ray
Fail-Safe
MWS
Ametrix
Shaper
io
Lumark
McGraw-Edison
Invue
Ephesus
Lumière
Streetworks
AtLite
Sure-Lites

Controls Product Lines

Greengate
iLumin
Zero 88
Fifth Light Technology
iLight (International Only)

Connected Lighting Systems

LumaWatt Pro
WaveLinx
Distributed Low-Voltage Power
ConnectWorks

Eaton

1121 Highway 74 South
Peachtree City, GA 30269
P: 770-486-4800
www.eaton.com/lighting

Canada Sales

5925 McLaughlin Road
Mississauga, Ontario L5R 1B8
P: 905-501-3000
F: 905-501-3172

© 2017 Eaton
All Rights Reserved
Printed in USA
Publication No. BR505013EN
June 1, 2017

Eaton is a registered trademark.

All other trademarks are property
of their respective owners.

Product availability, specifications,
and compliances are subject to
change without notice.



Powering Business Worldwide

Industrial LED luminaires
Exit and Emergency

Sure-Lites



EATON

Powering Business Worldwide

SEL/SELM Indoor

WAREHOUSE / DISTRIBUTION | MANUFACTURING | GYMNASIUMS / MULTI-PURPOSE ROOMS / ATHLETIC CENTER | BIG BOX / RETAIL

SEL



Polycarbonate

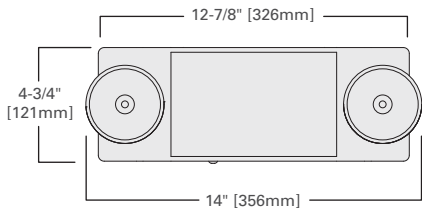

SELM



Metal

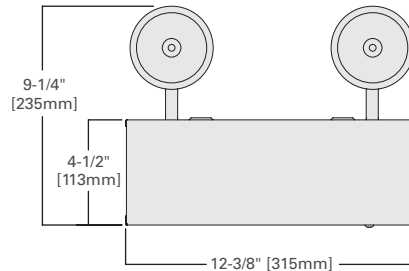

Feature	Benefit
Up to 60 feet of egress coverage	Up to \$300 savings on installation
LED source with Nickel cadmium battery	Up to ten years with no maintenance
Optional remote capacity	Indoor, outdoor design flexibility
Self diagnostics w/laser test	Reduce labor of NFPA/OSHA testing

Certification/warranty
UL924 damp location
NFPA 101 compliant
NEC/OSHA compliant
5-year product warranty
7-year prorated battery warranty



SEL60, SELM60

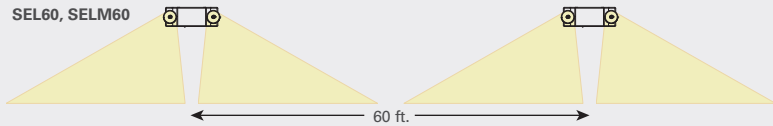

SELW/SELD Outdoor

WAREHOUSE / DISTRIBUTION | MANUFACTURING | GYMNASIUMS / MULTI-PURPOSE ROOMS / ATHLETIC CENTER | BIG BOX / RETAIL

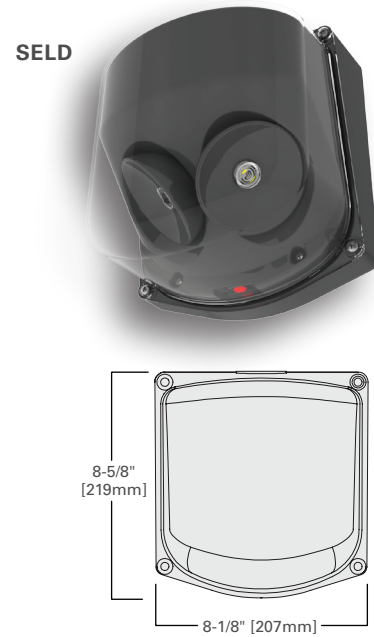
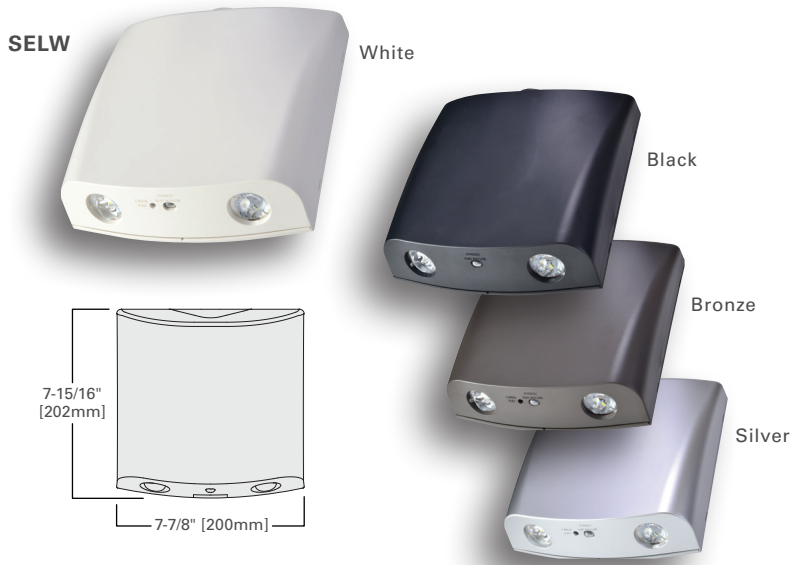

Feature	Benefit
LED source with Nickel cadmium battery	Up to ten years with no maintenance
Forward throw optic	Maximum design flexibility
29 feet spacing	Less fixtures required
Self diagnostics w/laser test	Reduce labor of NFPA/OSHA testing

Certification/warranty
UL924 wet location
NFPA 101 compliant
NEC/OSHA compliant
5-year product warranty
7-year prorated battery warranty

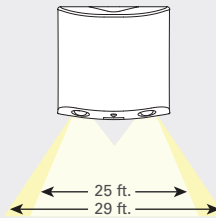

Feature	Benefit
LED source with Nickel cadmium battery	Up to ten years with no maintenance
58 foot spacing	Less fixtures required
Standard Self diagnostics with laser test	Reduce labor of NFPA/OSHA testing
NEMA 4X; IP66; - 30° C to 50° C	Maximum design flexibility

Certification
UL924 wet location
NEMA 4X
NFPA 101 compliant
NEC/OSHA compliant
IP66
NSF
IP66HAZ (class 1, Div 2) option

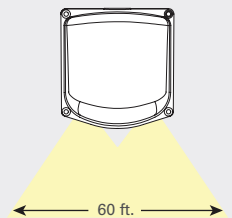

LPX Exit

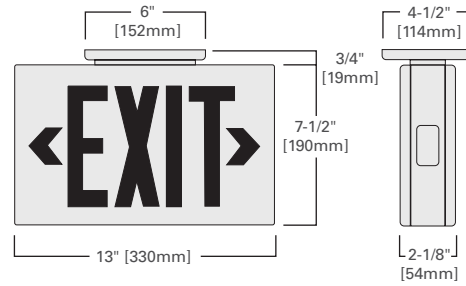

Feature	Benefit
LED source with Nickel cadmium battery	Up to ten years with no maintenance
Field adjustable for red or green	Maximum design flexibility
Optional emergency heads or remote capacity	Less fixtures required
Standard Self diagnostics with laser test	Reduce labor of NFPA/OSHA testing

Certification/warranty
UL924 damp location
NFPA 101 compliant
NEC/OSHA compliant
5-year product warranty
7-year prorated battery warranty



LPX LED Combo

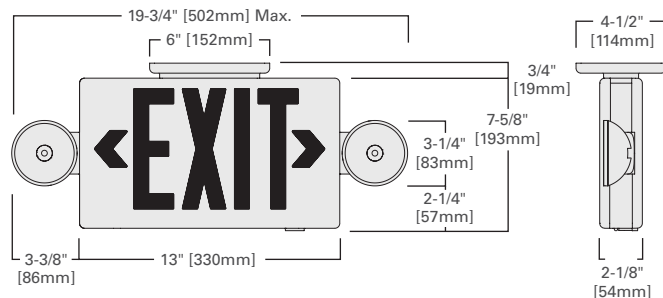

UX Exit

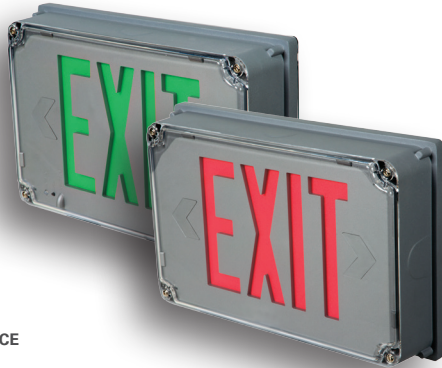

SINGLE FACE

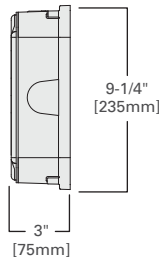
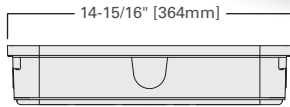

LPWX Exit

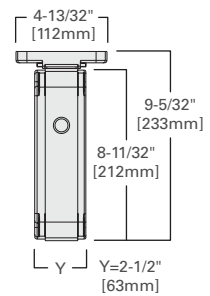
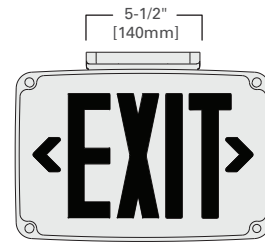
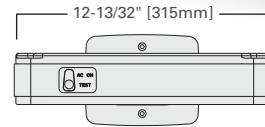

Feature	Benefit
LED source with Nickel cadmium battery	Up to ten years with no maintenance
Field adjustable for red or green	Maximum design flexibility
Standard Self diagnostics with laser test	Reduce labor of NFPA/OSHA testing
NEMA 4X; IP66; - 30° C to 50° C	Maximum design flexibility

Certification/warranty
UL924 wet location
NEMA 4X/IP66
NFPA 101 compliant
NEC/OSHA/NSF compliant
HAZ (class 1, Div 2) rated option
NSF
5-year product warranty, 7-year prorated battery warranty

Feature	Benefit
LED source with Nickel cadmium battery	Up to ten years with no maintenance
UV stabilized polycarbonate housing	Outdoor capable
Standard Self diagnostics with laser test	Reduce labor of NFPA/OSHA testing
Wet location listed; - 30° C to 50° C	Maximum design flexibility

Certification/warranty
UL924 wet location
NFPA 101 compliant
NEC/OSHA compliant
5-year product warranty, 7-year prorated battery warranty



Lighting Product Lines

Halo
Halo Commercial
Portfolio
Iris
RSA
Metalux
Corelite
Neo-Ray
Fail-Safe
MWS
Ametrix
Shaper
io
Lumark
McGraw-Edison
Invue
Ephesus
Lumière
Streetworks
AtLite
Sure-Lites

Controls Product Lines

Greengate
iLumin
Zero 88
Fifth Light Technology
iLight (International Only)

Connected Lighting Systems

LumaWatt Pro
WaveLinx
Distributed Low-Voltage Power
ConnectWorks

Eaton

1121 Highway 74 South
Peachtree City, GA 30269
P: 770-486-4800
www.eaton.com/lighting

Canada Sales

5925 McLaughlin Road
Mississauga, Ontario L5R 1B8
P: 905-501-3000
F: 905-501-3172

© 2017 Eaton
All Rights Reserved
Printed in USA
Publication No. BR505013EN
June 1, 2017

Eaton is a registered trademark.

All other trademarks are property
of their respective owners.

Product availability, specifications,
and compliances are subject to
change without notice.



Powering Business Worldwide