

WIREMOLD



24R Plugmold® INSTALLATION INSTRUCTIONS

Installation Instruction No.: 1 007 574 - February 2008

Wiremold / Legrand electrical systems conform to and should be properly grounded in compliance with requirements of the current National Electrical Code or codes administered by local authorities.

All electrical products may present a possible shock or fire hazard if improperly installed or used. Wiremold / Legrand electrical products may bear the mark as UL Listed and/or Classified and should be installed in conformance with current local and/or the National Electrical Code.

IMPORTANT: Please read all instructions before beginning.

BACKFEEDING 24R PLUGMOLD

Step 1 Remove appropriate 1/2" trade size knockout from the base.



Step 2 Feed cable through connector and attach the base to the 2451 or 1/2" trade size feed connector.



Step 3 Mount the 24R Plugmold base to the wall using No. 8 flat head screws every 32" max.



Step 4 Cap wires at the end of the harness on both sides using wire nuts.



Step 5 Cut and strip wires in appropriate location. Connect feed wires to the harness using wire nuts or W30 Connectors. (Wire Nuts and W30 Connectors are sold separately.)



Step 6 Snap 24R Plugmold cover onto the base.



END FEEDING 24R PLUGMOLD

Step 1 Mount 2400 box or 2410C entrance end fitting to the wall.



Step 2 Connect 24R Plugmold base to box or entrance end. Mount the 24R Plugmold base to the wall using No. 8 flat head screws.

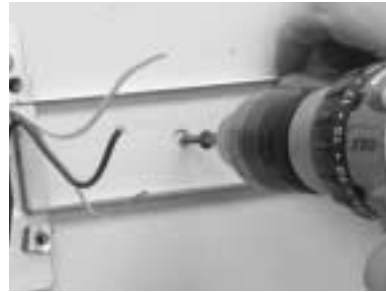

Step 3 Cap wire at the end of the harness on the non-feed side using wire nuts.



Step 4 Snap 24R Plugmold cover onto the base.



Step 5 Cut and strip wires in appropriate location. Connect feed wires to the harness using wire nuts or W30 Connectors. (Wire Nuts and W30 Connectors are sold separately.)



COUPLING AND CUTTING 24R PLUGMOLD

Coupling – 24R Plugmold may be coupled using 2401 Couplings.

Cutting – 24R Plugmold may be cut to length. If 24R Plugmold is cut a 2409 grounding clamp must be installed in each section of 24R Plugmold. 24R Plugmold has one 2409 factory installed per section. Additional 2409 may be purchased separately.

WIREMOLD

 **legrand**[®]

Wiremold / Legrand

U.S. and International:

60 Woodlawn Street • West Hartford, CT 06110

1-800-621-0049 • FAX 860-232-2062 • Outside U.S.: 860-233-6251

Canada:

570 Applewood Crescent • Vaughan, Ontario L4K 4B4

1-800-723-5175 • FAX 905-738-9721

